



JOUSIKOVAT RUOSTUMATTOMAT TERÄSNAUHAT JA ARKIT  
W1.4310 / AISI & SAE 301 / DIN X10CrNi18-8 / DIN X12CrNi17-7 / SS 2331

**50 kg KELAT / NAUHAT**

- 0,050 x 300 – 600
- 0,100 x 300 – 600
- 0,150 x 300 – 600
- 0,200 x 300 – 600
- 0,250 x 300 – 600
- 0,300 x 300 – 600
- 0,400 x 300 – 600
- 0,500 x 300 – 600

**ARKIT**

- 0,20 X 300 – 500 X 2400
- 0,30 X 300 – 500 X 2400
- 0,40 X 300 – 500 X 2400
- 0,50 X 300 – 500 X 2400
- 0,60 X 300 – 500 X 2400
- 0,70 X 300 – 500 X 2400
- 0,80 X 300 – 500 X 2400
- 1,00 X 300 – 500 X 2400
- 1,20 X 300 – 500 X 2400
- 1,50 X 300 – 500 X 2400
- 2,00 X 300 – 500 X 2400
- 2,50 X 300 – 500 X 2400
- 3,00 X 300 – 500 X 2400

- 0,10 X 1250 X 2000
- 0,20 X 1250 X 2000
- 0,25 X 1250 X 2000
- 0,30 X 1250 X 2000
- 0,40 X 1250 X 2000
- 0,50 X 1250 X 2000
- 0,60 X 1250 X 2000
- 0,70 X 1250 X 2000
- 0,80 X 1250 X 2000

AMPKO OY  
Rajatie 4 B 23  
FIN-01230 VANTAA  
Tel. +358-(0)9-2587 6060  
<https://www.ampko.com>  
Email: [info@ampko.com](mailto:info@ampko.com)

AMPKO OY  
Rajatie 4 B 23  
FIN-01230 VANTAA  
Tel. +358-(0)9-2587 6060  
<https://www.ampko.com>  
Email: [info@ampko.com](mailto:info@ampko.com)

AMPKO OY  
Rajatie 4 B 23  
FIN-01230 VANTAA  
Tel. +358-(0)9-2587 6060  
<https://www.ampko.com>  
Email: [info@ampko.com](mailto:info@ampko.com)

JOUSIKOVAT HAPONKESTÄVÄ TERÄSNAUHAT JA ARKIT  
W1.4404 / AISI & SAE 316 / DIN X 5 CrNiMo 17-12-2 / DIN X12CrNi17-7 / SS 2347

AMPKO OY  
Rajatie 4 B 23  
FIN-01230 VANTAA  
Tel. +358-(0)9-2587 6060  
<https://www.ampko.com>  
Email: [info@ampko.com](mailto:info@ampko.com)

AMPKO OY  
Rajatie 4 B 23  
FIN-01230 VANTAA  
Tel. +358-(0)9-2587 6060  
<https://www.ampko.com>  
Email: [info@ampko.com](mailto:info@ampko.com)

AMPKO OY  
Rajatie 4 B 23  
FIN-01230 VANTAA  
Tel. +358-(0)9-2587 6060  
<https://www.ampko.com>  
Email: [info@ampko.com](mailto:info@ampko.com)

**50 KG KELAT / NAUHAT**

**0,050 X 610**

**0,100 X 610**

**0,150 X 610**

**0,200 X 610**

**0,250 X 610**

**0,300 X 610**

**0,400 X 610**

**0,500 X 610**

**0,600 X 610**

**0,700 X 610**

**0,800 X 610**

AMPKO OY  
Rajatie 4 B 23  
FIN-01230 VANTAA  
Tel. +358-(0)9-2587 6060  
<https://www.ampko.com>  
Email: [info@ampko.com](mailto:info@ampko.com)

AMPKO OY  
Rajatie 4 B 23  
FIN-01230 VANTAA  
Tel. +358-(0)9-2587 6060  
<https://www.ampko.com>  
Email: [info@ampko.com](mailto:info@ampko.com)

AMPKO OY  
Rajatie 4 B 23  
FIN-01230 VANTAA  
Tel. +358-(0)9-2587 6060  
<https://www.ampko.com>  
Email: [info@ampko.com](mailto:info@ampko.com)

**ARKIT**

**0,100 X 610 X 2000**

**0,150 X 610 X 2000**

**0,200 X 610 X 2000**

**0,250 X 610 X 2000**

**0,300 X 610 X 2000**

**0,400 X 610 X 2000**

**0,500 X 610 X 2000**

**0,600 X 610 X 2000**

**0,700 X 610 X 2000**

**0,800 X 610 X 2000**

AMPKO OY  
Rajatie 4 B 23  
FIN-01230 VANTAA  
Tel. +358-(0)9-2587 6060  
<https://www.ampko.com>  
Email: [info@ampko.com](mailto:info@ampko.com)

AMPKO OY  
Rajatie 4 B 23  
FIN-01230 VANTAA  
Tel. +358-(0)9-2587 6060  
<https://www.ampko.com>  
Email: [info@ampko.com](mailto:info@ampko.com)

AMPKO OY  
Rajatie 4 B 23  
FIN-01230 VANTAA  
Tel. +358-(0)9-2587 6060  
<https://www.ampko.com>  
Email: [info@ampko.com](mailto:info@ampko.com)

AMPKO OY  
Rajatie 4 B 23  
FIN-01230 VANTAA  
Tel. +358-(0)9-2587 6060  
<https://www.ampko.com>  
Email: [info@ampko.com](mailto:info@ampko.com)

AMPKO OY  
Rajatie 4 B 23  
FIN-01230 VANTAA  
Tel. +358-(0)9-2587 6060  
<https://www.ampko.com>  
Email: [info@ampko.com](mailto:info@ampko.com)

AMPKO OY  
Rajatie 4 B 23  
FIN-01230 VANTAA  
Tel. +358-(0)9-2587 6060  
<https://www.ampko.com>  
Email: [info@ampko.com](mailto:info@ampko.com)

HIILITERÄKSET Ck 75 / W & EN 1.1248 / AISI 1075 JOUSIKOVANA

Rm 1000 – 2000 N/qmm

NORMAALIKOVANA Ck 75 / Ck 75 / W & EN 1.1248 / AISI 1075

Rm 500 – 800 N/qmm

0,50 x 300 – 600 x 2000 – 3000

1,00 x 300 – 600 x 2000 – 3000

1,50 x 300 – 600 x 2000 – 3000

2,00 x 300 – 600 x 2000 – 3000

2,50 x 300 – 600 x 2000 – 3000

3,00 x 300 – 600 x 2000 – 3000

3,50 x 300 – 600 x 2000 – 3000

4,00 x 300 – 600 x 2000 – 3000

4,50 x 300 – 600 x 2000 – 3000

JOUSITERÄKSET TANKOINA

AMPKO OY  
Rajatie 4 B 23  
FIN-01230 VANTAA  
Tel. +358-(0)9-2587 6060  
<https://www.ampko.com>  
Email: [info@ampko.com](mailto:info@ampko.com)

AMPKO OY  
Rajatie 4 B 23  
FIN-01230 VANTAA  
Tel. +358-(0)9-2587 6060  
<https://www.ampko.com>  
Email: [info@ampko.com](mailto:info@ampko.com)

AMPKO OY  
Rajatie 4 B 23  
FIN-01230 VANTAA  
Tel. +358-(0)9-2587 6060  
<https://www.ampko.com>  
Email: [info@ampko.com](mailto:info@ampko.com)

AMPKO OY  
Rajatie 4 B 23  
FIN-01230 VANTAA  
Tel. +358-(0)9-2587 6060  
<https://www.ampko.com>  
Email: [info@ampko.com](mailto:info@ampko.com)

AMPKO OY  
Rajatie 4 B 23  
FIN-01230 VANTAA  
Tel. +358-(0)9-2587 6060  
<https://www.ampko.com>  
Email: [info@ampko.com](mailto:info@ampko.com)

AMPKO OY  
Rajatie 4 B 23  
FIN-01230 VANTAA  
Tel. +358-(0)9-2587 6060  
<https://www.ampko.com>  
Email: [info@ampko.com](mailto:info@ampko.com)

LYIJYNAUHAT Pb 99,95 %

HETI VARASTOSTA

0,50 X 1000 mm

0,70 X 1000 mm

1,00 X 1000 mm

1,50 X 1000 mm

2,00 X 1000 mm

2,50 X 1000 mm

3,00 X 1000 mm

LYIJYN ASIAKAS-SOVELLUTUKSET Pb 99,50 %

OHUIN FOLIO 0,10 X min./max. mitoin 10 – 355 mm

PAKSUIN 120 X min./max. mitoin 500 – 1300 mm

MYÖS PUOLIVALMISTEET AUKOTETTUNA & ULKOMITOISSAAN

KAIKKI LYIJYTUOTTEET MYÖS TUKEVALLA POLYURETAANI SUOJAPINNOITEELLA

ALLAOLEVAN KUVAN MUKAAN MYÖS AUKOTETTUNA



LATTAMUODOT

FLAT BARS

\* EN 10058 – PERUS

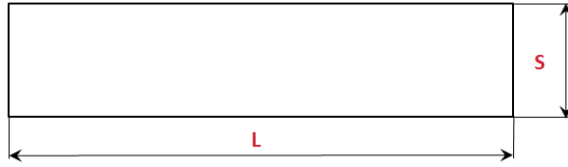

\* EN 10092.1 – PROFILE A

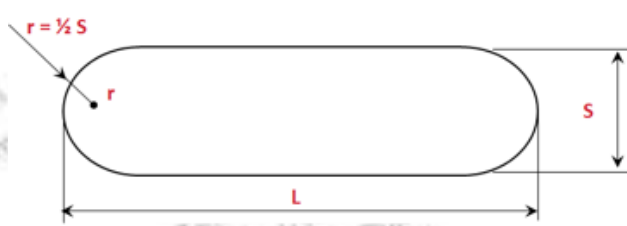

\* EN 10092.1 – PROFILE B

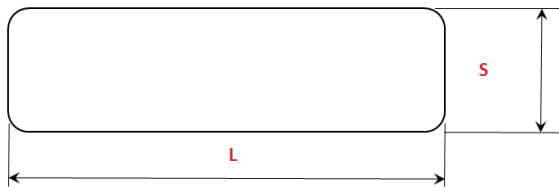

EN 10092.1 – PROFILE C

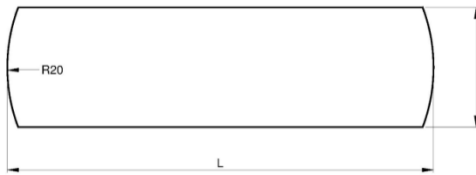

# VALSSATUT KEHÄT MONESSA ERI SEOKSESSA

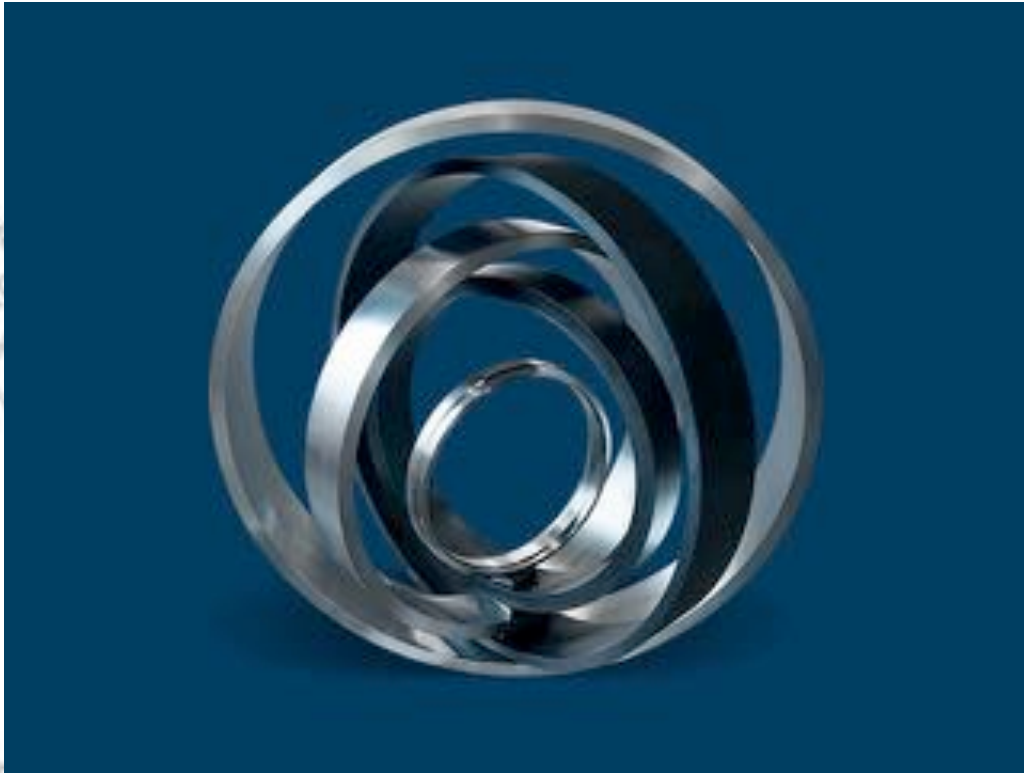

AMPKO OY  
Rajatie 4 B 23  
FIN-01230 VANTAA  
Tel. +358-(0)9-2587 6060  
<https://www.ampko.com>  
Email: [info@ampko.com](mailto:info@ampko.com)

AMPKO OY  
Rajatie 4 B 23  
FIN-01230 VANTAA  
Tel. +358-(0)9-2587 6060  
<https://www.ampko.com>  
Email: [info@ampko.com](mailto:info@ampko.com)

AMPKO OY  
Rajatie 4 B 23  
FIN-01230 VANTAA  
Tel. +358-(0)9-2587 6060  
<https://www.ampko.com>  
Email: [info@ampko.com](mailto:info@ampko.com)

AMPKO OY  
Rajatie 4 B 23  
FIN-01230 VANTAA  
Tel. +358-(0)9-2587 6060  
<https://www.ampko.com>  
Email: [info@ampko.com](mailto:info@ampko.com)

AMPKO OY  
Rajatie 4 B 23  
FIN-01230 VANTAA  
Tel. +358-(0)9-2587 6060  
<https://www.ampko.com>  
Email: [info@ampko.com](mailto:info@ampko.com)

AMPKO OY  
Rajatie 4 B 23  
FIN-01230 VANTAA  
Tel. +358-(0)9-2587 6060  
<https://www.ampko.com>  
Email: [info@ampko.com](mailto:info@ampko.com)

AMPKO OY  
Rajatie 4 B 23  
FIN-01230 VANTAA  
Tel. +358-(0)9-2587 6060  
<https://www.ampko.com>  
Email: [info@ampko.com](mailto:info@ampko.com)

AMPKO OY  
Rajatie 4 B 23  
FIN-01230 VANTAA  
Tel. +358-(0)9-2587 6060  
<https://www.ampko.com>  
Email: [info@ampko.com](mailto:info@ampko.com)

AMPKO OY  
Rajatie 4 B 23  
FIN-01230 VANTAA  
Tel. +358-(0)9-2587 6060  
<https://www.ampko.com>  
Email: [info@ampko.com](mailto:info@ampko.com)

AMPKO OY  
Rajatie 4 B 23  
FIN-01230 VANTAA  
Tel. +358-(0)9-2587 6060  
<https://www.ampko.com>  
Email: [info@ampko.com](mailto:info@ampko.com)

AMPKO OY  
Rajatie 4 B 23  
FIN-01230 VANTAA  
Tel. +358-(0)9-2587 6060  
<https://www.ampko.com>  
Email: [info@ampko.com](mailto:info@ampko.com)

TANKOTUOTTEET

Tuote	Koko	Pituus	Toleranssi	Varasto
1.4005-AISI 416+QT+C Cold Drawn Round	7,93	3050	h9	301
1.4005-AISI 416+QT+C Cold Drawn Round	7,93	3050	h9	46
1.4005-AISI 416+QT+C Cold Drawn Round	8	3050	h9	358
1.4005-AISI 416+QT+C Cold Drawn Round	11,112	3050	h9	253
1.4005-AISI 416+QT+C Cold Drawn Round	12,5	3050	h9	50
1.4005-AISI 416+QT+C Cold Drawn Round	12,7	3050	h9	592
1.4005-AISI 416+QT+C Cold Drawn Round	17	3050	h9	404
1.4005-AISI 416+QT+C Cold Drawn Round	17,475	3050	h9	89
1.4005-AISI 416+QT+C Cold Drawn Round	18	3050	h9	990
1.4005-AISI 416+QT+C Cold Drawn Round	18	3100	h9	1270
1.4005-AISI 416+QT+C Cold Drawn Round	18	3100	h9	1005
1.4005-AISI 416+QT+C Cold Drawn Round	22,5	3050	h9	3016
1.4005-AISI 416+QT+C-2H Cold Drawn Hexagon	15,875	3050	h11	7747
1.4005-AISI 416+QT+SH-2B Peeled Reeled Round	18,35	3100	h9	4264
1.4005-AISI 416+QT+SH-2B Peeled Reeled Round	41	4180	h10	671
1.4005-AISI 416+QT+SH-2B Peeled Reeled Round	60	3100	h9	1791
1.4005-AISI 416+QT+SH-2B Peeled Reeled Round	76,2	3100	h9	215
1.4005-AISI 416+QT+SL Ground Round	5,85	3050	h8	527
1.4005-AISI 416+QT+SL Ground Round	6	3050	h8	1477
1.4005-AISI 416+QT+SL Ground Round	14,63	3050	h7	1765
1.4005-AISI 416+QT+SL Ground Round	22	3100	h8	971
1.4005-AISI 416+QT+SL Ground Round	22	3100	h8	938

1.4005-AISI 416+QT+SL Ground Round	25	3100	h8	1160
1.4005-AISI 416+QT+SL Ground Round	30	3100	h8	1088
1.4005-AISI 416+QT+SL Ground Round	30	3100	h8	1262
1.4005-AISI 416+QT+SL Ground Round	38,1	3100	h8	734
1.4005-AISI 416+QT-1X Rough Machined Round	64,5	6200	h10	940
1.4005-AISI 416+QT-1X Rough Machined Round	65	3100	k13	507
1.4006-AISI 410+A+SH-2B Peeled Reeled Round	70,05	3100	h9	101
1.4006-AISI 410+A+SL Ground Round	25	3050	h9	476
1.4016-AISI 430+A+C Cold Drawn Round	5,2	3050	h9	5534
1.4016-AISI 430+A+C Cold Drawn Round	5,2	3050	h9	605
1.4016-AISI 430+A+C Cold Drawn Round	8	3050	h9	267
1.4016-AISI 430+A+C Cold Drawn Round	9	3050	h9	297
1.4016-AISI 430+A+C Cold Drawn Round	14	3050	h9	290
1.4016-AISI 430+A+C Cold Drawn Round	26	3050	h9	595
1.4016-AISI 430+A+SL Ground Round	7	4050	h9	1812
1.4016-AISI 430+A+SL Ground Round	7	4050	h9	396
1.4016-AISI 430+A+SL Ground Round	7	4050	h9	4961
1.4016-AISI 430+A+SL Ground Round	8	3050	h9	663
1.4016-AISI 430+A+SL Ground Round	8	3050	h9	574
1.4016-AISI 430+A+SL Ground Round	8	6050	h9	977
1.4016-AISI 430+A+SL Ground Round	10	6050	h9	805
1.4016-AISI 430+A+SL Ground Round	10	6050	h9	839
1.4016-AISI 430+A+SL Ground Round	13	3050	h9	518
1.4016-AISI 430+A+SL Ground Round	18	3200	h9	7374

1.4016-AISI 430+A+SL Ground Round	18	3200	h9	5689
1.4016-AISI 430+A+SL Ground Round	18	3200	h9	2874
1.4016-AISI 430+A+SL Ground Round	20	3200	h9	5238
1.4021 Medical+A+C-2H Cold Drawn Round	9	3050	h9	180
1.4021 Medical+A+C-2H Cold Drawn Round	10	3050	h9	340
1.4021 Medical+A+C-2H Cold Drawn Round	10	3050	h9	134
1.4021 Medical+A+C-2H Cold Drawn Round	10	3050	h9	152
1.4021 Medical+A+C-2H Cold Drawn Round	14	3050	h9	133
1.4021 Medical+A+C-2H Cold Drawn Round	20	3050	h9	169
1.4021 Medical+A+C-2H Cold Drawn Round	26	3050	h8	336
1.4021 Medical+A+SL Ground Round	5	3050	h9	425
1.4021 Medical+A+SL Ground Round	11	3050	h8	909
1.4021(AISI 420)+A+SL Ground Round	7	4050	h9	4422
1.4021(AISI 420)+A+SL Ground Round	8	4050	h9	7514
1.4021(AISI 420)+A+SL Ground Round	8	6050	h9	2675
1.4021(AISI 420)+A+SL Ground Round	8	6050	h9	5149
1.4021(AISI 420)+A+SL Ground Round	9	3050	h8	703
1.4021(AISI 420)+A+SL Ground Round	9	3050	h8	593
1.4021(AISI 420)+A+SL Ground Round	9	3050	h8	162
1.4021(AISI 420)+A+SL Ground Round	9	3050	h8	5148
1.4021(AISI 420)+A+SL Ground Round	9	3050	h8	431
1.4021(AISI 420)+A+SL Ground Round	9	3050	h8	723
1.4021(AISI 420)+A+SL Ground Round	9	3050	h8	660
1.4021(AISI 420)+A+SL Ground Round	9	3050	h8	1948

1.4021(AISI 420)+A+SL Ground Round	9	3050	h8	917
1.4021(AISI 420)+A+SL Ground Round	9	3050	h8	851
1.4021(AISI 420)+A+SL Ground Round	9	3050	h8	747
1.4021(AISI 420)+A+SL Ground Round	9	3050	h8	1788
1.4021(AISI 420)+A+SL Ground Round	9	3050	h8	804
1.4021(AISI 420)+A+SL Ground Round	9	3050	h8	1369
1.4021(AISI 420)+A+SL Ground Round	9	3050	h8	574
1.4021(AISI 420)+A+SL Ground Round	9	3050	h8	2772
1.4021(AISI 420)+A+SL Ground Round	9	3050	h8	500
1.4021(AISI 420)+A+SL Ground Round	9	3050	h8	3651
1.4021(AISI 420)+A+SL Ground Round	9	3050	h8	2016
1.4021(AISI 420)+A+SL Ground Round	9	3050	h8	947
1.4021(AISI 420)+A+SL Ground Round	9	3050	h9	261
1.4021(AISI 420)+A+SL Ground Round	9	3050	h9	380
1.4021(AISI 420)+A+SL Ground Round	9	4050	h8	309
1.4021(AISI 420)+A+SL Ground Round	9	4050	h9	1383
1.4021(AISI 420)+A+SL Ground Round	9	4050	h9	409
1.4021(AISI 420)+A+SL Ground Round	9	4050	h9	8202
1.4021(AISI 420)+A+SL Ground Round	9	4050	h9	161
1.4021(AISI 420)+A+SL Ground Round	9	4050	h9	614
1.4021(AISI 420)+A+SL Ground Round	9	4050	h9	13821
1.4021(AISI 420)+A+SL Ground Round	9	4050	h9	1104
1.4021(AISI 420)+A+SL Ground Round	9,18	3050	h7	1084
1.4021(AISI 420)+A+SL Ground Round	9,21	3150	h8	218

1.4021(AISI 420)+A+SL Ground Round	10	3050	h8	250
1.4021(AISI 420)+A+SL Ground Round	10	3050	h8	264
1.4021(AISI 420)+A+SL Ground Round	10	3050	h9	248
1.4021(AISI 420)+A+SL Ground Round	10	4050	h8	596
1.4021(AISI 420)+A+SL Ground Round	10	4050	h9	2257
1.4021(AISI 420)+A+SL Ground Round	10	4050	h9	2155
1.4021(AISI 420)+A+SL Ground Round	10	4050	h9	6151
1.4021(AISI 420)+A+SL Ground Round	10	4050	h9	1087
1.4021(AISI 420)+A+SL Ground Round	10	6050	h9	18195
1.4021(AISI 420)+A+SL Ground Round	12	3050	h9	699
1.4021(AISI 420)+A+SL Ground Round	16	3050	f8	723
1.4021(AISI 420)+A+SL Ground Round	30	3200	h9	116
1.4021(AISI 420)+A+SL Ground Round	45	3200	h8	471
1.4021-(AISI 420)+A+C-2H Cold Drawn Round	6	3050	h9	503
1.4021-(AISI 420)+A+C-2H Cold Drawn Round	6,2	3050	h9	983
1.4021-(AISI 420)+A+C-2H Cold Drawn Round	8	4050	h9	231
1.4021-(AISI 420)+A+C-2H Cold Drawn Round	9	3050	h9	757
1.4021-(AISI 420)+A+C-2H Cold Drawn Round	9	3050	h9	604
1.4021-(AISI 420)+A+C-2H Cold Drawn Round	9	3050	h9	1100
1.4021-(AISI 420)+A+C-2H Cold Drawn Round	9	3050	h9	253
1.4021-(AISI 420)+A+C-2H Cold Drawn Round	9	4050	h9	600
1.4021-(AISI 420)+A+C-2H Cold Drawn Round	10	3050	h9	149
1.4021-(AISI 420)+A+C-2H Cold Drawn Round	11	3050	h9	703
1.4021-(AISI 420)+A+C-2H Cold Drawn Round	12	3050	h9	542

1.4021-(AISI 420)+A+C-2H Cold Drawn Round	13	3050	h9	307
1.4021-(AISI 420)+A+C-2H Cold Drawn Round	14	3050	h9	1013
1.4021-(AISI 420)+A+C-2H Cold Drawn Round	16	3050	h9	737
1.4021-(AISI 420)+A+C-2H Cold Drawn Round	16	3050	h9	431
1.4021-(AISI 420)+A+C-2H Cold Drawn Round	16	3050	h9	972
1.4021-(AISI 420)+A+C-2H Cold Drawn Round	16	3050	h9	2323
1.4021-(AISI 420)+A+C-2H Cold Drawn Round	16	3050	h9	266
1.4021-(AISI 420)+A+C-2H Cold Drawn Round	16	3180	h8	781
1.4021-(AISI 420)+A+C-2H Cold Drawn Round	16	3180	h8	767
1.4021-(AISI 420)+A+C-2H Cold Drawn Round	18	3050	h9	706
1.4021-(AISI 420)+A+C-2H Cold Drawn Round	20	3050	h9	438
1.4021-(AISI 420)+A+C-2H Cold Drawn Round	20	3050	h9	864
1.4021-(AISI 420)+A+C-2H Cold Drawn Round	20	3050	h9	588
1.4021-(AISI 420)+A+C-2H Cold Drawn Round	20	3200	h9	602
1.4021-(AISI 420)+A+C-2H Cold Drawn Round	20	3180	h9	881
1.4021-(AISI 420)+A+C-2H Cold Drawn Round	22	3050	h9	433
1.4021-(AISI 420)+A+C-2H Cold Drawn Round	22	6100	h9	956
1.4021-(AISI 420)+A+C-2H Cold Drawn Round	22	6100	h9	1458
1.4021-(AISI 420)+A+C-2H Cold Drawn Round	24	3050	h9	823
1.4021-(AISI 420)+A+C-2H Cold Drawn Round	25	4510	h9	152
1.4021-(AISI 420)+A+C-2H Cold Drawn Round	25	6050	h9	182
1.4021-(AISI 420)+A+C-2H Cold Drawn Round	26	3050	h9	162
1.4021-(AISI 420)+A+C-2H Cold Drawn Round	26	3050	h9	422
1.4021-(AISI 420)+A+C-2H Cold Drawn Round	28	3050	h9	172

1.4021-(AISI 420)+A+SL Ground Round	8	3100	h8	405
1.4021-(AISI 420)+A+SL Ground Round	9	4300	h8	288
1.4021-(AISI 420)+A+SL Ground Round	9,18	3050	h7	11414
1.4021-(AISI 420)+A+SL Ground Round	9,218	3050	h7	970
1.4021-(AISI 420)+A+SL Ground Round	10	3050	h8	171
1.4021-(AISI 420)+A+SL Ground Round	10	3050	h8	1018
1.4021-(AISI 420)+A+SL Ground Round	10	3050	h8	851
1.4021-(AISI 420)+A+SL Ground Round	10	3050	h9	749
1.4021-(AISI 420)+A+SL Ground Round	10	3050	h9	913
1.4021-(AISI 420)+A+SL Ground Round	12	3100	h8	412
1.4021-(AISI 420)+A+SL Ground Round	18	3100	h8	1184
1.4021-(AISI 420)+A+SL Ground Round	20	3100	h8	1836
1.4021-(AISI 420)+A+SL Ground Round	20	3180	h9	63
1.4021-(AISI 420)+A+SL Ground Round	22	3050	h9	44
1.4021-(AISI 420)+A+SL Ground Round	22	3100	h8	240
1.4021-(AISI 420)+A+SL Ground Round	25	3100	h8	918
1.4021-(AISI 420)+A+SL Ground Round	25	3180	h8	966
1.4021-(AISI 420)+A+SL Ground Round	25	5750	h8	2176
1.4021-(AISI 420)+QT+C-2H Cold Drawn Round	7	3050	h9	510
1.4021-(AISI 420)+QT+C-2H Cold Drawn Round	12	3050	h10	943
1.4021-(AISI 420)+QT+C-2H Cold Drawn Round	20	3100	h9	306
1.4021-(AISI 420)+QT+C-2H Cold Drawn Round	27	3050	h9	361
1.4021-(AISI 420)+QT+C-2H Cold Drawn Round	27	3050	h9	507
1.4021-(AISI 420)+QT+SL Ground Round	7	3050	h7	500

1.4021-(AISI 420)+QT+SL Ground Round	13	3050	h8	179
1.4021-(AISI 420)+QT+SL Ground Round	14	3050	h9	2568
1.4028-(AISI 420)+A+C-2H Cold Drawn Round	5	3050	h9	504
1.4028-(AISI 420)+A+C-2H Cold Drawn Round	16	6100	h9	477
1.4028-(AISI 420)+A+C-2H Cold Drawn Round	20	6100	h9	630
1.4028-(AISI 420)+A+C-2H Cold Drawn Round	24	3080	h9	919
1.4028-(AISI 420)+A+C-2H Cold Drawn Round	24	3080	h9	5065
1.4028-(AISI 420)+A+C-2H Cold Drawn Round	25	6050	h9	136
1.4028-(AISI 420)+A+SL Ground Round	16	6100	h8	695
1.4028-(AISI 420)+A+SL Ground Round	20	3100	h8	557
1.4028-(AISI 420)+A+SL Ground Round	25	3100	h8	363
1.4028-(AISI 420)+QT+C-2H Cold Drawn Round	17	3050	h9	883
1.4028-(AISI 420)+QT+C-2H Cold Drawn Round	22	6100	h9	267
1.4028-(AISI 420)+QT+C-2H Cold Drawn Round	24	3050	h9	183
1.4028-(AISI 420)+QT+SH-2B Peeled Reeled Round	20	3050	h9	953
1.4028-(AISI 420)+QT+SH-2B Peeled Reeled Round	20	6050	h9	833
1.4028-(AISI 420)+QT+SH-2B Peeled Reeled Round	38	3100	h9	1824
1.4028-(AISI 420)+QT+SH-2B Peeled Reeled Round	38	3100	h9	970
1.4028-(AISI 420)+QT+SH-2B Peeled Reeled Round	50,12	3050	h9	839
1.4028-(AISI 420)+QT+SL Ground Round	18	3100	h8	1138
1.4028-(AISI 420)+QT+SL Ground Round	20	3100	h8	1284
1.4028-(AISI 420)+QT+SL Ground Round	22	3050	h8	971
1.4028-(AISI 420)+QT+SL Ground Round	25	6050	h8	684
1.4028-(AISI 420)+QT+SL Ground Round	25	6050	h8	591

1.4028-(AISI 420)Hot Roll.+QT-1X Rough Mach. Round	80	5500	k12	1491
1.4029- AISI 420F) +A+C Cold Drawn Round	10,3	3050	h9	345
1.4029- AISI 420F) +A+C Cold Drawn Round	20	3050	h9	130
1.4029- AISI 420F) +A+C Cold Drawn Round	30	3050	h9	967
1.4034 DE+AC+C-2H Cold Drawn Round	14	3050	h9	143
1.4034 DE+AC+C-2H Cold Drawn Round	14	3050	h9	4794
1.4034 DE+AC+SL Ground Round	14,3	3050	h8	1280
1.4034-(AISI 420)+A+C-2H Cold Drawn Round	3	3050	h9	487
1.4034-(AISI 420)+A+C-2H Cold Drawn Round	6	3050	h9	977
1.4034-(AISI 420)+A+C-2H Cold Drawn Round	6	3100	h9	987
1.4034-(AISI 420)+A+C-2H Cold Drawn Round	8	3050	h9	481
1.4034-(AISI 420)+A+C-2H Cold Drawn Round	8	3050	h9	210
1.4034-(AISI 420)+A+C-2H Cold Drawn Round	8	3050	h9	574
1.4034-(AISI 420)+A+C-2H Cold Drawn Round	8	3050	h9	288
1.4034-(AISI 420)+A+C-2H Cold Drawn Round	8	3100	h9	433
1.4034-(AISI 420)+A+C-2H Cold Drawn Round	8,25	3100	h11	740
1.4034-(AISI 420)+A+C-2H Cold Drawn Round	10	3050	h9	408
1.4034-(AISI 420)+A+C-2H Cold Drawn Round	10	3050	h9	175
1.4034-(AISI 420)+A+C-2H Cold Drawn Round	12	3050	h9	675
1.4034-(AISI 420)+A+C-2H Cold Drawn Round	12	3050	h9	425
1.4034-(AISI 420)+A+C-2H Cold Drawn Round	12	3050	h9	212
1.4034-(AISI 420)+A+C-2H Cold Drawn Round	12,2	3050	h9	300
1.4034-(AISI 420)+A+C-2H Cold Drawn Round	12,2	3050	h9	286

1.4034-(AISI 420)+A+C-2H Cold Drawn Round	14	3050	h9	367
1.4034-(AISI 420)+A+C-2H Cold Drawn Round	14	3050	h9	967
1.4034-(AISI 420)+A+C-2H Cold Drawn Round	14	3050	h9	2036
1.4034-(AISI 420)+A+C-2H Cold Drawn Round	14	3050	h9	481
1.4034-(AISI 420)+A+C-2H Cold Drawn Round	14	4000	h9	564
1.4034-(AISI 420)+A+C-2H Cold Drawn Round	14	6000	h9	573
1.4034-(AISI 420)+A+C-2H Cold Drawn Round	14,3	3050	k10	656
1.4034-(AISI 420)+A+C-2H Cold Drawn Round	20	0	h8	205
1.4034-(AISI 420)+A+C-2H Cold Drawn Round	20	3050	h8	667
1.4034-(AISI 420)+A+C-2H Cold Drawn Round	20	3050	h9	1720
1.4034-(AISI 420)+A+C-2H Cold Drawn Round	20	3050	h9	672
1.4034-(AISI 420)+A+C-2H Cold Drawn Round	20	3050	h9	554
1.4034-(AISI 420)+A+C-2H Cold Drawn Round	20	3050	h9	585
1.4034-(AISI 420)+A+C-2H Cold Drawn Round	20	3050	h9	263
1.4034-(AISI 420)+A+C-2H Cold Drawn Round	20	3050	h9	2387
1.4034-(AISI 420)+A+C-2H Cold Drawn Round	20	3050	h9	360
1.4034-(AISI 420)+A+C-2H Cold Drawn Round	20	3050	h9	416
1.4034-(AISI 420)+A+C-2H Cold Drawn Round	20	3050	h9	1141
1.4034-(AISI 420)+A+C-2H Cold Drawn Round	20	3050	h9	233
1.4034-(AISI 420)+A+C-2H Cold Drawn Round	20	3050	h9	535
1.4034-(AISI 420)+A+C-2H Cold Drawn Round	20	3050	h9	694
1.4034-(AISI 420)+A+C-2H Cold Drawn Round	20	3050	h9	1364
1.4034-(AISI 420)+A+C-2H Cold Drawn Round	20	3050	h9	439
1.4034-(AISI 420)+A+C-2H Cold Drawn Round	20	6050	h9	659

1.4034-(AISI 420)+A+C-2H Cold Drawn Round	20	6050	h9	690
1.4034-(AISI 420)+A+C-2H Cold Drawn Round	20	6100	h9	616
1.4034-(AISI 420)+A+C-2H Cold Drawn Round	20,15	2950	h9	489
1.4034-(AISI 420)+A+C-2H Cold Drawn Round	20,15	3050	h9	1015
1.4034-(AISI 420)+A+C-2H Cold Drawn Round	20,15	3150	h9	524
1.4034-(AISI 420)+A+C-2H Cold Drawn Round	20,4	6050	h9	200
1.4034-(AISI 420)+A+C-2H Cold Drawn Round	21	3050	h9	356
1.4034-(AISI 420)+A+C-2H Cold Drawn Round	21	3050	h9	1149
1.4034-(AISI 420)+A+C-2H Cold Drawn Round	21	3050	h9	339
1.4034-(AISI 420)+A+C-2H Cold Drawn Round	21	3050	h9	113
1.4034-(AISI 420)+A+C-2H Cold Drawn Round	21	3050	h9	1069
1.4034-(AISI 420)+A+C-2H Cold Drawn Round	22	3050	h8	735
1.4034-(AISI 420)+A+C-2H Cold Drawn Round	22	3050	h9	1638
1.4034-(AISI 420)+A+C-2H Cold Drawn Round	22	3050	h9	3143
1.4034-(AISI 420)+A+C-2H Cold Drawn Round	22	3050	h9	922
1.4034-(AISI 420)+A+C-2H Cold Drawn Round	22	3050	h9	4612
1.4034-(AISI 420)+A+C-2H Cold Drawn Round	22	6100	h9	444
1.4034-(AISI 420)+A+C-2H Cold Drawn Round	22	6100	h9	705
1.4034-(AISI 420)+A+C-2H Cold Drawn Round	22,2	3050	h9	1532
1.4034-(AISI 420)+A+C-2H Cold Drawn Round	24	3050	h9	296
1.4034-(AISI 420)+A+C-2H Cold Drawn Round	25	3050	h9	951
1.4034-(AISI 420)+A+C-2H Cold Drawn Round	25	3050	h9	2666
1.4034-(AISI 420)+A+C-2H Cold Drawn Round	25	3100	h9	1396
1.4034-(AISI 420)+A+C-2H Cold Drawn Round	25	6050	h8	5698

1.4034-(AISI 420)+A+C-2H Cold Drawn Round	25	6050	h9	796
1.4034-(AISI 420)+A+C-2H Cold Drawn Round	26	3050	h9	150
1.4034-(AISI 420)+A+SL Ground Round	4,5	3050	h8	127
1.4034-(AISI 420)+A+SL Ground Round	8	3100	h8	952
1.4034-(AISI 420)+A+SL Ground Round	12	3050	h8	646
1.4034-(AISI 420)+A+SL Ground Round	14	6000	h7	468
1.4034-(AISI 420)+A+SL Ground Round	16,15	3200	h9	1003
1.4034-(AISI 420)+A+SL Ground Round	16,15	3200	h9	1996
1.4034-(AISI 420)+A+SL Ground Round	20	3050	h8	797
1.4034-(AISI 420)+A+SL Ground Round	20	3050	h8	1333
1.4034-(AISI 420)+A+SL Ground Round	20	3050	h8	395
1.4034-(AISI 420)+A+SL Ground Round	20	3100	h8	211
1.4034-(AISI 420)+A+SL Ground Round	20	6100	h8	1071
1.4034-(AISI 420)+A+SL Ground Round	20	6100	h8	3787
1.4034-(AISI 420)+A+SL Ground Round	20	6100	h8	1202
1.4034-(AISI 420)+A+SL Ground Round	22	3100	h8	388
1.4034-(AISI 420)+A+SL Ground Round	25	3100	h8	756
1.4034-(AISI 420)+A+SL Ground Round	25	6200	h8	230
1.4034-(AISI 420)+A+SL Ground Round	30	3100	h8	185
1.4034-(AISI 420)+A+SL Ground Round	30	3100	h8	800
1.4034-(AISI 420)+A+SL Ground Round	40,2	6200	h9	1328
1.4035+A+SL Ground Round	3,1	3500	h9	469
1.4035+A+SL Ground Round	7	3050	h6	58
1.4035+A+SL Ground Round	32	3050	h10	19

1.4036-(AISI 304L)+AT+C-2H Cold Drawn Round	25	3050	h9	257
1.4057-AISI 431+A+SL Ground Round	10	4050	h8	210
1.4057-AISI 431+QT+C-2H Cold Drawn Round	10,22	3050	h9	558
1.4057-AISI 431+QT+C-2H Cold Drawn Round	10,22	4050	h9	326
1.4057-AISI 431+QT+C-2H Cold Drawn Round	10,22	4050	h9	414
1.4057-AISI 431+QT+C-2H Cold Drawn Round	10,22	4050	h9	420
1.4057-AISI 431+QT+C-2H Cold Drawn Round	12	3050	h9	373
1.4057-AISI 431+QT+C-2H Cold Drawn Round	13	3050	h9	134
1.4057-AISI 431+QT+C-2H Cold Drawn Round	14,28	3050	h9	253
1.4057-AISI 431+QT+C-2H Cold Drawn Round	15	3050	h9	164
1.4057-AISI 431+QT+C-2H Cold Drawn Round	16	1520	h9	522
1.4057-AISI 431+QT+C-2H Cold Drawn Round	16	1520	h9	490
1.4057-AISI 431+QT+C-2H Cold Drawn Round	18	4000	h9	2561
1.4057-AISI 431+QT+C-2H Cold Drawn Round	20,3	3100	h9	1000
1.4057-AISI 431+QT+C-2H Cold Drawn Round	21	3050	h8	97
1.4057-AISI 431+QT+C-2H Cold Drawn Round	21	3050	h9	858
1.4057-AISI 431+QT+SH-2B Peeled Reeled Round	38	3100	h9	14
1.4057-AISI 431+QT+SH-2B Peeled Reeled Round	55,12	3050	h9	898
1.4057-AISI 431+QT+SH-2B Peeled Reeled Round	70	3200	k10	378
1.4057-AISI 431+QT+SL Ground Round	6	3050	h8	500
1.4057-AISI 431+QT+SL Ground Round	8	3050	h8	1672
1.4057-AISI 431+QT+SL Ground Round	10	4050	h8	450
1.4057-AISI 431+QT+SL Ground Round	18	3050	h8	201
1.4057-AISI 431+QT+SL Ground Round	18	3400	h7	966

1.4057-AISI 431+QT+SL Ground Round	18	4000	h8	569
1.4057-AISI 431+QT+SL Ground Round	18	4000	h8	160
1.4057-AISI 431+QT+SL Ground Round	18	4000	h8	733
1.4057-AISI 431+QT+SL Ground Round	20	3050	h9	560
1.4057-AISI 431+QT+SL Ground Round	20	3100	h8	247
1.4057-AISI 431+QT+SL Ground Round	20	3100	h8	1084
1.4057-AISI 431+QT+SL Ground Round	22	3050	h9	126
1.4057-AISI 431+QT+SL Ground Round	22	3100	h8	969
1.4057-AISI 431+QT+SL Ground Round	25	3050	h8	139
1.4057-AISI 431+QT+SL Ground Round	25	3050	h8	1582
1.4057-AISI 431+QT+SL Ground Round	25	3050	h9	194
1.4057-AISI 431+QT+SL Ground Round	25	3050	h9	447
1.4057-AISI 431+QT+SL Ground Round	25	3050	h9	447
1.4057-AISI 431+QT+SL Ground Round	25	3100	h8	1250
1.4057-AISI 431+QT+SL Ground Round	26	3050	h9	927
1.4057-AISI 431+QT+SL Ground Round	30	3050	h8	743
1.4057-AISI 431+QT+SL Ground Round	30	3200	h8	783
1.4057-AISI 431+QT+SL Ground Round	35	3200	h8	1875
1.4057-AISI 431+QT+SL Ground Round	35	3200	h8	488
1.4057-AISI 431+QT+SL Ground Round	40	3200	h8	958
1.4057-AISI 431+QT+SL Ground Round	55	3200	h8	984
1.4057-AISI 431+QT+SL Ground Round	55	6200	h8	902
1.4057-AISI 431+QT+SL Ground Round	70	3200	h8	898
1.4057-AISI 431+QT-1X Rough Machined Round	35	3100	k10	1845

1.4057-AISI 431+QT-1X Rough Machined Round	35	3100	k10	782
1.4057-AISI 431+QT-1X Rough Machined Round	40	3100	k10	2810
1.4057-AISI 431+QT-1X Rough Machined Round	45	3100	k10	2108
1.4057-AISI 431+QT-1X Rough Machined Round	50	3100	k10	2556
1.4057-AISI 431+QT-1X Rough Machined Round	55	3100	k10	2071
1.4057-AISI 431+QT-1X Rough Machined Round	60	3100	k10	1748
1.4057-AISI 431+QT-1X Rough Machined Round	65	3100	k10	1583
1.4104+A+C-2H Cold Drawn Hexagon	13	3050	h11	284
1.4104+A+C-2H Cold Drawn Hexagon	13	3050	h11	695
1.4104+A+C-2H Cold Drawn Hexagon	13	3050	h11	630
1.4104+A+C-2H Cold Drawn Hexagon	13	3050	h11	203
1.4104+A+C-2H Cold Drawn Round	5	3050	h9	90
1.4104+A+C-2H Cold Drawn Round	6,1	4100	h9	572
1.4104+A+C-2H Cold Drawn Round	6,5	3050	h10	375
1.4104+A+C-2H Cold Drawn Round	6,7	3050	h9	235
1.4104+A+C-2H Cold Drawn Round	8	0	h9	584
1.4104+A+C-2H Cold Drawn Round	8	3050	h9	540
1.4104+A+C-2H Cold Drawn Round	8	3050	h9	477
1.4104+A+C-2H Cold Drawn Round	8	3050	h9	280
1.4104+A+C-2H Cold Drawn Round	8	3100	h9	354
1.4104+A+C-2H Cold Drawn Round	8	3100	h9	235
1.4104+A+C-2H Cold Drawn Round	8	3150	h9	697
1.4104+A+C-2H Cold Drawn Round	8	3150	h9	435
1.4104+A+C-2H Cold Drawn Round	8	3150	h9	713

1.4104+A+C-2H Cold Drawn Round	8	3150	h9	1617
1.4104+A+C-2H Cold Drawn Round	8	3150	h9	1056
1.4104+A+C-2H Cold Drawn Round	8	3150	h9	294
1.4104+A+C-2H Cold Drawn Round	8	3150	h9	576
1.4104+A+C-2H Cold Drawn Round	8	3150	h9	1360
1.4104+A+C-2H Cold Drawn Round	8	3150	h9	377
1.4104+A+C-2H Cold Drawn Round	8	3150	h9	368
1.4104+A+C-2H Cold Drawn Round	8	3150	h9	382
1.4104+A+C-2H Cold Drawn Round	8	3150	h9	293
1.4104+A+C-2H Cold Drawn Round	8	3150	h9	215
1.4104+A+C-2H Cold Drawn Round	8	3150	h9	494
1.4104+A+C-2H Cold Drawn Round	9,97	3050	h9	180
1.4104+A+C-2H Cold Drawn Round	10	1550	h9	218
1.4104+A+C-2H Cold Drawn Round	10,85	3050	h9	113
1.4104+A+C-2H Cold Drawn Round	11	1550	h9	1007
1.4104+A+C-2H Cold Drawn Round	11	3050	h9	158
1.4104+A+C-2H Cold Drawn Round	11	3050	h9	4765
1.4104+A+C-2H Cold Drawn Round	11	3050	h9	103
1.4104+A+C-2H Cold Drawn Round	11	3050	h9	150
1.4104+A+C-2H Cold Drawn Round	12,7	3050	h9	105
1.4104+A+C-2H Cold Drawn Round	14,58	3050	h9	108
1.4104+A+C-2H Cold Drawn Round	16	2050	h9	400
1.4104+A+C-2H Cold Drawn Round	16	5020	h9	377
1.4104+A+C-2H Cold Drawn Round	16	6150	h8	357

1.4104+A+C-2H Cold Drawn Round	16	6150	h9	460
1.4104+A+C-2H Cold Drawn Round	17,5	3050	h9	212
1.4104+A+C-2H Cold Drawn Round	17,5	3050	h9	374
1.4104+A+C-2H Cold Drawn Round	18	3050	h9	481
1.4104+A+C-2H Cold Drawn Round	20	3050	h9	270
1.4104+A+C-2H Cold Drawn Round	20	3050	h9	167
1.4104+A+C-2H Cold Drawn Round	20	3050	h9	57
1.4104+A+C-2H Cold Drawn Round	20	3050	h9	407
1.4104+A+C-2H Cold Drawn Round	20	3050	h9	153
1.4104+A+C-2H Cold Drawn Round	20	3050	h9	160
1.4104+A+C-2H Cold Drawn Round	20	3350	h9	868
1.4104+A+C-2H Cold Drawn Round	20	3350	h9	959
1.4104+A+C-2H Cold Drawn Round	20	3350	h9	1601
1.4104+A+C-2H Cold Drawn Round	22	3050	h9	433
1.4104+A+C-2H Cold Drawn Round	22	3050	h9	615
1.4104+A+C-2H Cold Drawn Round	22	3050	h9	659
1.4104+A+C-2H Cold Drawn Round	24	3200	h9	221
1.4104+A+C-2H Cold Drawn Round	24	3350	h8	69
1.4104+A+C-2H Cold Drawn Round	24	3350	h9	885
1.4104+A+C-2H Cold Drawn Round	24	3550	h9	537
1.4104+A+C-2H Cold Drawn Round	24	3550	h9	305
1.4104+A+C-2H Cold Drawn Round	24	4050	h8	124
1.4104+A+C-2H Cold Drawn Round	24	4050	h9	208
1.4104+A+C-2H Cold Drawn Round	24	4050	h9	403

1.4104+A+C-2H Cold Drawn Round	24,05	3300	h9	244
1.4104+A+C-2H Cold Drawn Round	25	3050	h9	23
1.4104+A+C-2H Cold Drawn Round	25	3050	h9	1000
1.4104+A+C-2H Cold Drawn Round	27	3100	h9	527
1.4104+A+SH-2B Peeled Reeled Round	40,12	3200	h9	123
1.4104+A+SH-2B Peeled Reeled Round	42	3050	h10	166
1.4104+A+SH-2B Peeled Reeled Round	56	3100	h9	237
1.4104+A+SL Ground Round	4	3050	h9	65
1.4104+A+SL Ground Round	6	3100	h8	2740
1.4104+A+SL Ground Round	6	3100	h8	1692
1.4104+A+SL Ground Round	6	3100	h8	503
1.4104+A+SL Ground Round	6,63	3170	h8	190
1.4104+A+SL Ground Round	8	2050	h8	305
1.4104+A+SL Ground Round	8	3150	h8	284
1.4104+A+SL Ground Round	8	3150	h8	2518
1.4104+A+SL Ground Round	8	3150	h8	1132
1.4104+A+SL Ground Round	8	3150	h8	487
1.4104+A+SL Ground Round	8	3150	h8	1329
1.4104+A+SL Ground Round	8	3150	h8	211
1.4104+A+SL Ground Round	8	3150	h8	763
1.4104+A+SL Ground Round	8	3150	h8	1281
1.4104+A+SL Ground Round	8	3350	h8	1676
1.4104+A+SL Ground Round	8	4050	h8	368
1.4104+A+SL Ground Round	8,1	3100	h9	80

1.4104+A+SL Ground Round	8,12	3150	h8	2039
1.4104+A+SL Ground Round	8,12	3150	h8	1005
1.4104+A+SL Ground Round	8,12	3150	h8	23915
1.4104+A+SL Ground Round	8,12	3150	h8	1897
1.4104+A+SL Ground Round	8,12	3150	h8	508
1.4104+A+SL Ground Round	8,12	3150	h8	1230
1.4104+A+SL Ground Round	10,93	3050	h8	240
1.4104+A+SL Ground Round	11	3050	h8	1018
1.4104+A+SL Ground Round	11	3100	h8	2513
1.4104+A+SL Ground Round	13	3100	h8	446
1.4104+A+SL Ground Round	15	3050	h10	367
1.4104+A+SL Ground Round	16	3050	h8	764
1.4104+A+SL Ground Round	16	5050	h8	692
1.4104+A+SL Ground Round	16	5050	h8	354
1.4104+A+SL Ground Round	16	5050	h8	576
1.4104+A+SL Ground Round	17	3050	h8	518
1.4104+A+SL Ground Round	18	3100	h8	1740
1.4104+A+SL Ground Round	20	2050	h8	1078
1.4104+A+SL Ground Round	20	2050	h8	556
1.4104+A+SL Ground Round	20	3100	h8	476
1.4104+A+SL Ground Round	20	3350	h8	230
1.4104+A+SL Ground Round	20	3350	h8	1568
1.4104+A+SL Ground Round	20	3350	h8	661
1.4104+A+SL Ground Round	20	3350	h8	273

1.4104+A+SL Ground Round	20	3350	h8	745
1.4104+A+SL Ground Round	20	6150	h8	310
1.4104+A+SL Ground Round	21	3100	h8	5246
1.4104+A+SL Ground Round	22	3050	h9	290
1.4104+A+SL Ground Round	23,2	3050	h6	186
1.4104+A+SL Ground Round	24	3350	h8	46
1.4104+A+SL Ground Round	24	3350	h8	81
1.4104+A+SL Ground Round	26	3100	h8	878
1.4104+A+SL Ground Round	30	3050	h8	1582
1.4104+A+SL Ground Round	30	3050	h9	436
1.4104+QT+C-2H Cold Drawn Round	16	3050	h9	404
1.4104+QT+SL Ground Round	18,1	3100	h8	118
1.4104+QT+SL Ground Round	20	3200	h9	3169
1.4104+QT+SL Ground Round	20	3200	h9	427
1.4104+QT+SL Ground Round	24	3050	h8	230
1.4105-AISI 430F+A(M)+SL Ground Round	8,53	2550	h8	777
1.4105-AISI 430F+A+C-2H Cold Drawn Round	7,5	3050	h9	197
1.4105-AISI 430F+A+C-2H Cold Drawn Round	10	3050	h9	967
1.4105-AISI 430F+A+SL Ground Round	7,5	3000	h8	885
1.4105-AISI 430F+A+SL Ground Round	9,5	3050	h8	236
1.4105-AISI 430F+A+SL Ground Round	9,5	3050	h8	285
1.4105Si+A(M)+SL Ground Round	6	3000	r7	288
1.4105Si+A(M)+SL Ground Round	9	3050	h8	127
1.4105Si+A(M)+SL Ground Round	14	3000	h8	368

1.4106 MOD+A(M)+SL Ground Round	8	3050	h8	3304
1.4106 MOD+A(M)+SL Ground Round	8,85	3200	h8	844
1.4106 MOD+A(M)+SL Ground Round	8,85	3200	h8	532
1.4106 MOD+A(M)+SL Ground Round	9	3050	h8	242
1.4106 MOD+A(M)+SL Ground Round	10	3050	h8	120
1.4106 MOD+A(M)+SL Ground Round	10,8	3050	h8	286
1.4106 MOD+A+SL Ground Round	10	3500		211
1.4106+A+C-2H Cold Drawn Round	8	3050	h9	481
1.4112+A+SL Ground Round	9	3050	h8	450
1.4112+A+SL Ground Round	9	3050	h8	931
1.4112+A+SL Ground Round	18	3050	h8	224
1.4112+A+SL Ground Round	18	3050	h9	378
1.4112+A+SL Ground Round	22	3050	h9	337
1.4112+A+SL Ground Round	25	3050	h8	512
1.4112+A+SL Ground Round	25	3050	h8	230
1.4112+A+SL Ground Round	25	6200	h8	926
1.4112+A+SL Ground Round	30	3100	h9	1024
1.4112+A+SL Ground Round	30	3200	h8	678
1.4112+A+SL Ground Round	30	3200	h9	230
1.4112+A+SL Ground Round	30	6500	h9	273
1.4112-AISI 440B+A+C-2H Cold Drawn Round	6	3050	h9	677
1.4112-AISI 440B+A+C-2H Cold Drawn Round	6,5	3050	h9	1516
1.4112-AISI 440B+A+C-2H Cold Drawn Round	6,5	3050	h9	670
1.4112-AISI 440B+A+C-2H Cold Drawn Round	8	3050	h9	412

1.4112-AISI 440B+A+C-2H Cold Drawn Round	8,3	6150	h9	142
1.4112-AISI 440B+A+C-2H Cold Drawn Round	10	3050	h9	762
1.4112-AISI 440B+A+C-2H Cold Drawn Round	12	3050	h9	327
1.4112-AISI 440B+A+C-2H Cold Drawn Round	12	3050	h9	354
1.4112-AISI 440B+A+C-2H Cold Drawn Round	14	3050	h9	367
1.4112-AISI 440B+A+C-2H Cold Drawn Round	15	3100	h9	607
1.4112-AISI 440B+A+C-2H Cold Drawn Round	16	6200	h9	612
1.4112-AISI 440B+A+C-2H Cold Drawn Round	16	6200	h9	416
1.4112-AISI 440B+A+C-2H Cold Drawn Round	18	3200	h9	182
1.4112-AISI 440B+A+SH-2B Peeled Reeled Round	50,3	6200	k10	372
1.4114/XM-34+A+SL Ground Round	14,3	3050	h8	900
1.4116+A+C-2H Cold Drawn Round	8	3050	h9	342
1.4116+A+C-2H Cold Drawn Round	20	6100	h9	204
1.4116+A+C-2H Cold Drawn Round	20,3	3100	h9	780
1.4116+A+C-2H Cold Drawn Round	20,3	6100	h9	596
1.4116+A+C-2H Cold Drawn Round	25,3	6100	h9	415
1.4122+A+C-2H Cold Drawn Round	8	3050	h9	230
1.4122+A+C-2H Cold Drawn Round	10	3050	h9	638
1.4122+A+C-2H Cold Drawn Round	12	4350	h9	87
1.4122+A+C-2H Cold Drawn Round	12	4350	h9	454
1.4122+A+C-2H Cold Drawn Round	12	4350	h9	516
1.4122+A+C-2H Cold Drawn Round	12,2	3050	h9	188
1.4122+A+SL Ground Round	6	3050	h7	518
1.4122+A+SL Ground Round	6	3050	h7	974

1.4122+A+SL Ground Round	10,1	3050	h8	351
1.4122+QT+C-2H Cold Drawn Round	12	3050	h9	73
1.4122+QT+C-2H Cold Drawn Round	20	6200	h9	252
1.4122+QT+C-2H Cold Drawn Round	20	6200	h9	308
1.4122+QT+SH-2B Peeled Reeled Round	40	6200	h9	237
1.4122+QT+SL Ground Round	6	3050	h8	362
1.4122+QT+SL Ground Round	10	3050	h8	447
1.4125-AISI 440C+A+C-2H Cold Drawn Round	9	3050	h9	37
1.4125-AISI 440C+A+C-2H Cold Drawn Round	15	3000	h9	237
1.4301/1.4307(Spec.)+AT+C-2H Trafilato Tondo	7,135	3050	h9	1554
1.4301/1.4307(Spec.)+AT+C-2H Trafilato Tondo	7,135	3050	h9	759
1.4301/1.4307(Spec.)+AT+C-2H Trafilato Tondo	7,6	3050	h9	1000
1.4301/1.4307(Spec.)+AT+C-2H Trafilato Tondo	7,6	3050	h9	2109
1.4301/1.4307(Spec.)+AT+C-2H Trafilato Tondo	7,6	3050	h9	965
1.4301/1.4307+AT+C Cold Drawn Square	14	3050	h11	1642
1.4301/1.4307+AT+C Cold Drawn Square	15	3050	h11	1501
1.4301/1.4307+AT+C Cold Drawn Square	18	3050	h11	1477
1.4301/1.4307+AT+C Cold Drawn Square	40	6100	h11	6408
1.4301/1.4307+AT+C Cold Drawn Square	40	6100	h11	2744
1.4301/1.4307+AT+C-2H Cold Drawn Hexagon	6	3100	h11	540
1.4301/1.4307+AT+C-2H Cold Drawn Hexagon	14	3050	h11	13
1.4301/1.4307+AT+C-2H Cold Drawn Hexagon	17	3200	h11	74
1.4301/1.4307+AT+C-2H Cold Drawn Hexagon	18	3050	h11	1789
1.4301/1.4307+AT+C-2H Cold Drawn Hexagon	22	3050	h11	841

1.4301/1.4307+AT+C-2H Cold Drawn Hexagon	27	3050	h11	3546
1.4301/1.4307+AT+C-2H Cold Drawn Hexagon	27	3050	h11	945
1.4301/1.4307+AT+C-2H Cold Drawn Hexagon	38	3050	h11	729
1.4301/1.4307+AT+C-2H Cold Drawn Hexagon	38	3050	h11	371
1.4301/1.4307+AT+C-2H Cold Drawn Hexagon	38	3200	h11	611
1.4301/1.4307+AT+C-2H Cold Drawn Round	4	3050	h9	500
1.4301/1.4307+AT+C-2H Cold Drawn Round	4	3050	h9	295
1.4301/1.4307+AT+C-2H Cold Drawn Round	4	3050	h9	502
1.4301/1.4307+AT+C-2H Cold Drawn Round	5	3050	h9	1700
1.4301/1.4307+AT+C-2H Cold Drawn Round	5,5	3100	h9	501
1.4301/1.4307+AT+C-2H Cold Drawn Round	7	3100	h9	1197
1.4301/1.4307+AT+C-2H Cold Drawn Round	7	3100	h9	1728
1.4301/1.4307+AT+C-2H Cold Drawn Round	7,135	3050	js9	727
1.4301/1.4307+AT+C-2H Cold Drawn Round	7,135	3050	js9	390
1.4301/1.4307+AT+C-2H Cold Drawn Round	7,6	3050	h9	45
1.4301/1.4307+AT+C-2H Cold Drawn Round	7,6	3050	h9	303
1.4301/1.4307+AT+C-2H Cold Drawn Round	8	3050	h9	141
1.4301/1.4307+AT+C-2H Cold Drawn Round	8	3050	h9	862
1.4301/1.4307+AT+C-2H Cold Drawn Round	8	6100	h9	272
1.4301/1.4307+AT+C-2H Cold Drawn Round	9,525	3050	h9	76
1.4301/1.4307+AT+C-2H Cold Drawn Round	10	3050	h9	505
1.4301/1.4307+AT+C-2H Cold Drawn Round	10	3050	h9	286
1.4301/1.4307+AT+C-2H Cold Drawn Round	10,5	3050	h9	1003
1.4301/1.4307+AT+C-2H Cold Drawn Round	11	3050	h9	965

1.4301/1.4307+AT+C-2H Cold Drawn Round	12	3050	h9	60
1.4301/1.4307+AT+C-2H Cold Drawn Round	12	3850	h9	3022
1.4301/1.4307+AT+C-2H Cold Drawn Round	12	3850	h9	1072
1.4301/1.4307+AT+C-2H Cold Drawn Round	12	4000	h9	283
1.4301/1.4307+AT+C-2H Cold Drawn Round	12	4000	h9	354
1.4301/1.4307+AT+C-2H Cold Drawn Round	12	6050	h9	343
1.4301/1.4307+AT+C-2H Cold Drawn Round	13	3050	h9	1014
1.4301/1.4307+AT+C-2H Cold Drawn Round	13	3050	h9	1998
1.4301/1.4307+AT+C-2H Cold Drawn Round	14,5	3050	h9	94
1.4301/1.4307+AT+C-2H Cold Drawn Round	14,55	3050	h9	906
1.4301/1.4307+AT+C-2H Cold Drawn Round	15	3050	h9	2026
1.4301/1.4307+AT+C-2H Cold Drawn Round	15	3050	h9	607
1.4301/1.4307+AT+C-2H Cold Drawn Round	15	3050	h9	316
1.4301/1.4307+AT+C-2H Cold Drawn Round	15	3050	h9	606
1.4301/1.4307+AT+C-2H Cold Drawn Round	15	6050	h9	3175
1.4301/1.4307+AT+C-2H Cold Drawn Round	15,5	3050	h9	216
1.4301/1.4307+AT+C-2H Cold Drawn Round	16	5100	h9	2116
1.4301/1.4307+AT+C-2H Cold Drawn Round	19	3050	h9	933
1.4301/1.4307+AT+C-2H Cold Drawn Round	19	3050	h9	1014
1.4301/1.4307+AT+C-2H Cold Drawn Round	19	3050	h9	276
1.4301/1.4307+AT+C-2H Cold Drawn Round	19	3050	h9	760
1.4301/1.4307+AT+C-2H Cold Drawn Round	20	3050	h9	1322
1.4301/1.4307+AT+C-2H Cold Drawn Round	20	3050	h9	414
1.4301/1.4307+AT+C-2H Cold Drawn Round	21	3050	h9	215

1.4301/1.4307+AT+C-2H Cold Drawn Round	21	3050	h9	431
1.4301/1.4307+AT+C-2H Cold Drawn Round	21	3050	h9	350
1.4301/1.4307+AT+C-2H Cold Drawn Round	21	3050	h9	860
1.4301/1.4307+AT+C-2H Cold Drawn Round	22	3050	h9	336
1.4301/1.4307+AT+C-2H Cold Drawn Round	23	3050	h9	490
1.4301/1.4307+AT+C-2H Cold Drawn Round	23	3050	h9	226
1.4301/1.4307+AT+C-2H Cold Drawn Round	24	3050	h9	433
1.4301/1.4307+AT+C-2H Cold Drawn Round	25	3050	h9	350
1.4301/1.4307+AT+C-2H Cold Drawn Round	25,4	3050	h9	240
1.4301/1.4307+AT+C-2H Cold Drawn Round	28	3050	h9	146
1.4301/1.4307+AT+SH-2B Peeled Reeled Round	20,12	6200	h9	6536
1.4301/1.4307+AT+SH-2B Peeled Reeled Round	25,12	6200	h9	1738
1.4301/1.4307+AT+SH-2B Peeled Reeled Round	32,5	3050	h9	542
1.4301/1.4307+AT+SH-2B Peeled Reeled Round	35	3200	h9	1011
1.4301/1.4307+AT+SH-2B Peeled Reeled Round	35,12	3050	h9	1482
1.4301/1.4307+AT+SH-2B Peeled Reeled Round	35,12	3050	h9	872
1.4301/1.4307+AT+SH-2B Peeled Reeled Round	35,12	3050	h9	486
1.4301/1.4307+AT+SH-2B Peeled Reeled Round	38	3100	h11	111
1.4301/1.4307+AT+SH-2B Peeled Reeled Round	40	6100	h9	121
1.4301/1.4307+AT+SH-2B Peeled Reeled Round	40,08	6100	h9	426
1.4301/1.4307+AT+SH-2B Peeled Reeled Round	40,12	3050	h9	820
1.4301/1.4307+AT+SH-2B Peeled Reeled Round	45	3100	h10	37
1.4301/1.4307+AT+SH-2B Peeled Reeled Round	45	3100	h9	916
1.4301/1.4307+AT+SH-2B Peeled Reeled Round	45	3100	h9	838

1.4301/1.4307+AT+SH-2B Peeled Reeled Round	45	3100	h9	838
1.4301/1.4307+AT+SH-2B Peeled Reeled Round	45	3100	h9	840
1.4301/1.4307+AT+SH-2B Peeled Reeled Round	47,12	3100	h9	1970
1.4301/1.4307+AT+SH-2B Peeled Reeled Round	50,12	3050	h9	2640
1.4301/1.4307+AT+SH-2B Peeled Reeled Round	55	3100	h9	687
1.4301/1.4307+AT+SH-2B Peeled Reeled Round	55	3100	h9	805
1.4301/1.4307+AT+SH-2B Peeled Reeled Round	55,12	3050	h9	866
1.4301/1.4307+AT+SH-2B Peeled Reeled Round	55,12	3050	h9	4178
1.4301/1.4307+AT+SH-2B Peeled Reeled Round	65	6100	h9	477
1.4301/1.4307+AT+SH-2B Peeled Reeled Round	65,12	3050	h9	1765
1.4301/1.4307+AT+SH-2B Peeled Reeled Round	68	3100	h9	88
1.4301/1.4307+AT+SH-2B Peeled Reeled Round	80,18	6100	h9	243
1.4301/1.4307+AT+SH-2B Peeled Reeled Round	85,12	3050	h9	547
1.4301/1.4307+AT+SH-2B Peeled Reeled Round	85,12	3050	h9	2445
1.4301/1.4307+AT+SH-2B Peeled Reeled Round	90,12	3500	h8	925
1.4301/1.4307+AT+SH-2B Peeled Reeled Round	96	3100	h9	522
1.4301/1.4307+AT+SH-2B Peeled Reeled Round	100	3050	h9	1112
1.4301/1.4307+AT+SH-2B Peeled Reeled Round	100,12	3100	h9	2272
1.4301/1.4307+AT+SH-2B Peeled Reeled Round	100,12	3100	h9	3424
1.4301/1.4307+AT+SH-2B Peeled Reeled Round	101,6	4267	ASTMA484	803
1.4301/1.4307+AT+SL Ground Round	3	3050	h8	350
1.4301/1.4307+AT+SL Ground Round	4	3050	h8	1039
1.4301/1.4307+AT+SL Ground Round	5	3050	h7	204
1.4301/1.4307+AT+SL Ground Round	5	3050	h9	492

1.4301/1.4307+AT+SL Ground Round	5	3050	h9	141
1.4301/1.4307+AT+SL Ground Round	5,96	3050	h7	401
1.4301/1.4307+AT+SL Ground Round	6	3050	h6	810
1.4301/1.4307+AT+SL Ground Round	6	3050	h8	1731
1.4301/1.4307+AT+SL Ground Round	6	3050	h8	570
1.4301/1.4307+AT+SL Ground Round	6	3050	h9	77
1.4301/1.4307+AT+SL Ground Round	6,2	3050	h8	900
1.4301/1.4307+AT+SL Ground Round	7	3050	h6	478
1.4301/1.4307+AT+SL Ground Round	7	3050	h9	332
1.4301/1.4307+AT+SL Ground Round	7	4050	h9	2605
1.4301/1.4307+AT+SL Ground Round	9	3050	h8	682
1.4301/1.4307+AT+SL Ground Round	10	3050	h8	277
1.4301/1.4307+AT+SL Ground Round	10	3050	h8	786
1.4301/1.4307+AT+SL Ground Round	10	3050	h8	775
1.4301/1.4307+AT+SL Ground Round	10	3050	h8	588
1.4301/1.4307+AT+SL Ground Round	10	3050	h8	1002
1.4301/1.4307+AT+SL Ground Round	10	3050	h8	235
1.4301/1.4307+AT+SL Ground Round	10	6050	h8	301
1.4301/1.4307+AT+SL Ground Round	12	3050	h10	78
1.4301/1.4307+AT+SL Ground Round	12	3050	h8	175
1.4301/1.4307+AT+SL Ground Round	12	4000	h7	490
1.4301/1.4307+AT+SL Ground Round	12	4000	h7	408
1.4301/1.4307+AT+SL Ground Round	12	4000	h7	217
1.4301/1.4307+AT+SL Ground Round	12	4000	h7	2051

1.4301/1.4307+AT+SL Ground Round	12	4000	h9	245
1.4301/1.4307+AT+SL Ground Round	12	6100	h6	430
1.4301/1.4307+AT+SL Ground Round	13	3050	h8	710
1.4301/1.4307+AT+SL Ground Round	13	3050	h8	320
1.4301/1.4307+AT+SL Ground Round	13	3050	h8	288
1.4301/1.4307+AT+SL Ground Round	13	3050	h8	202
1.4301/1.4307+AT+SL Ground Round	14	3050	h8	359
1.4301/1.4307+AT+SL Ground Round	14	3050	h8	422
1.4301/1.4307+AT+SL Ground Round	14	6050	h8	330
1.4301/1.4307+AT+SL Ground Round	14	6100	h9	579
1.4301/1.4307+AT+SL Ground Round	15	3050	h8	971
1.4301/1.4307+AT+SL Ground Round	15	3050	h8	963
1.4301/1.4307+AT+SL Ground Round	15	3050	h8	971
1.4301/1.4307+AT+SL Ground Round	15	3050	h9	1960
1.4301/1.4307+AT+SL Ground Round	15	3050	h9	151
1.4301/1.4307+AT+SL Ground Round	15	3050	h9	446
1.4301/1.4307+AT+SL Ground Round	15	3130	h9	181
1.4301/1.4307+AT+SL Ground Round	15	6050	h8	327
1.4301/1.4307+AT+SL Ground Round	15	6050	h8	368
1.4301/1.4307+AT+SL Ground Round	15	6050	h8	370
1.4301/1.4307+AT+SL Ground Round	16	3050	h8	226
1.4301/1.4307+AT+SL Ground Round	16	3050	h8	400
1.4301/1.4307+AT+SL Ground Round	16	3050	h8	545
1.4301/1.4307+AT+SL Ground Round	16	3050	h8	391

1.4301/1.4307+AT+SL Ground Round	16	3050	h8	455
1.4301/1.4307+AT+SL Ground Round	16	3050	h8	409
1.4301/1.4307+AT+SL Ground Round	16	3050	h8	388
1.4301/1.4307+AT+SL Ground Round	16	3050	h8	650
1.4301/1.4307+AT+SL Ground Round	17	3050	h8	879
1.4301/1.4307+AT+SL Ground Round	17	3050	h8	1886
1.4301/1.4307+AT+SL Ground Round	18	3050	h8	302
1.4301/1.4307+AT+SL Ground Round	18	3050	h8	520
1.4301/1.4307+AT+SL Ground Round	18	3050	h8	546
1.4301/1.4307+AT+SL Ground Round	18	3050	h8	471
1.4301/1.4307+AT+SL Ground Round	18	3050	h8	676
1.4301/1.4307+AT+SL Ground Round	18	3050	h9	523
1.4301/1.4307+AT+SL Ground Round	18	6050	h8	460
1.4301/1.4307+AT+SL Ground Round	18	6100	h6	1104
1.4301/1.4307+AT+SL Ground Round	20	3050	h8	239
1.4301/1.4307+AT+SL Ground Round	20	3050	h8	775
1.4301/1.4307+AT+SL Ground Round	20	3050	h9	4124
1.4301/1.4307+AT+SL Ground Round	20	3050	h9	497
1.4301/1.4307+AT+SL Ground Round	20	6050	h8	642
1.4301/1.4307+AT+SL Ground Round	21	3050	h8	84
1.4301/1.4307+AT+SL Ground Round	22	3050	h8	209
1.4301/1.4307+AT+SL Ground Round	22	3050	h9	779
1.4301/1.4307+AT+SL Ground Round	22	3100	h8	2439
1.4301/1.4307+AT+SL Ground Round	24	3050	h9	529

1.4301/1.4307+AT+SL Ground Round	24	3050	h9	22
1.4301/1.4307+AT+SL Ground Round	24	6000	h9	509
1.4301/1.4307+AT+SL Ground Round	24	6000	h8	961
1.4301/1.4307+AT+SL Ground Round	24	6000	h8	320
1.4301/1.4307+AT+SL Ground Round	24	6050	h8	1036
1.4301/1.4307+AT+SL Ground Round	24	6050	h8	2292
1.4301/1.4307+AT+SL Ground Round	24	6050	h8	557
1.4301/1.4307+AT+SL Ground Round	25	3025	h9	35
1.4301/1.4307+AT+SL Ground Round	25	3050	h8	860
1.4301/1.4307+AT+SL Ground Round	25	3050	h8	539
1.4301/1.4307+AT+SL Ground Round	25	3050	h9	3167
1.4301/1.4307+AT+SL Ground Round	25	3050	h9	35
1.4301/1.4307+AT+SL Ground Round	25	6050	h7	1517
1.4301/1.4307+AT+SL Ground Round	25	6050	h8	955
1.4301/1.4307+AT+SL Ground Round	25	6050	h8	653
1.4301/1.4307+AT+SL Ground Round	25	6050	h8	677
1.4301/1.4307+AT+SL Ground Round	25	6050	h9	583
1.4301/1.4307+AT+SL Ground Round	25	6100	h7	94
1.4301/1.4307+AT+SL Ground Round	25	6200	h9	864
1.4301/1.4307+AT+SL Ground Round	26	3100	h9	3634
1.4301/1.4307+AT+SL Ground Round	27	3050	h9	866
1.4301/1.4307+AT+SL Ground Round	27	3100		4994
1.4301/1.4307+AT+SL Ground Round	28	3100	h9	794
1.4301/1.4307+AT+SL Ground Round	28	3100	h9	2214

1.4301/1.4307+AT+SL Ground Round	28	3100	k10	136
1.4301/1.4307+AT+SL Ground Round	29	3100	h9	4786
1.4301/1.4307+AT+SL Ground Round	30	3050	h7	446
1.4301/1.4307+AT+SL Ground Round	30	3050	h8	220
1.4301/1.4307+AT+SL Ground Round	30	3050	h9	4988
1.4301/1.4307+AT+SL Ground Round	30	3050	h9	959
1.4301/1.4307+AT+SL Ground Round	30	3100	h7	958
1.4301/1.4307+AT+SL Ground Round	30	3100	h8	1467
1.4301/1.4307+AT+SL Ground Round	32	3050	h8	2370
1.4301/1.4307+AT+SL Ground Round	32	3100	h9	487
1.4301/1.4307+AT+SL Ground Round	34	3100	h9	1598
1.4301/1.4307+AT+SL Ground Round	35	3050	h9	1880
1.4301/1.4307+AT+SL Ground Round	35	3100	h8	986
1.4301/1.4307+AT+SL Ground Round	36	3050	h8	1964
1.4301/1.4307+AT+SL Ground Round	36	3050	h8	3258
1.4301/1.4307+AT+SL Ground Round	38	3050	h8	1940
1.4301/1.4307+AT+SL Ground Round	38	3050	h9	552
1.4301/1.4307+AT+SL Ground Round	38	3050	h9	722
1.4301/1.4307+AT+SL Ground Round	38	3050	h9	646
1.4301/1.4307+AT+SL Ground Round	38	3100	h9	1164
1.4301/1.4307+AT+SL Ground Round	40	6100	h10	60
1.4301/1.4307+AT+SL Ground Round	40	6100	h9	60
1.4301/1.4307+AT+SL Ground Round	42	3050	h8	1068
1.4301/1.4307+AT+SL Ground Round	42	3200	h8	866

1.4301/1.4307+AT+SL Ground Round	45	3200	h9	38
1.4301/1.4307+AT+SL Ground Round	46	3100		3856
1.4301/1.4307+AT+SL Ground Round	46	3100	h9	1698
1.4301/1.4307+AT+SL Ground Round	46	3100	h9	160
1.4301/1.4307+AT+SL Ground Round	46	3100	h9	4856
1.4301/1.4307+AT+SL Ground Round	48	3100	h9	2472
1.4301/1.4307+AT+SL Ground Round	48	3200	h6	132
1.4301/1.4307+AT+SL Ground Round	50	3100	h9	328
1.4301/1.4307+AT+SL Ground Round	50	3100	h9	94
1.4301/1.4307+AT+SL Ground Round	50	6100	h7	845
1.4301/1.4307+AT+SL Ground Round	50	6100	h8	940
1.4301/1.4307+AT+SL Ground Round	55	3050	h8	2642
1.4301/1.4307+AT+SL Ground Round	55	3100	h8	173
1.4301/1.4307+AT+SL Ground Round	55	3100	h9	2612
1.4301/1.4307+AT+SL Ground Round	57	3050	h8	739
1.4301/1.4307+AT+SL Ground Round	57	3050	h8	2265
1.4301/1.4307+AT+SL Ground Round	57	3100	h8	505
1.4301/1.4307+AT+SL Ground Round	60	6100	h7	816
1.4301/1.4307+AT+SL Ground Round	65	3050	h8	642
1.4301/1.4307+AT+SL Ground Round	65	3050	h8	1759
1.4301/1.4307+AT+SL Ground Round	65	3100	h9	160
1.4301/1.4307+AT+SL Ground Round	65	3100	h9	1620
1.4301/1.4307+AT+SL Ground Round	70	3050	h6	466
1.4301/1.4307+AT+SL Ground Round	75	3050	f7	1271

1.4301/1.4307+AT+SL Ground Round	75	3050	h8	854
1.4301/1.4307+AT+SL Ground Round	75	3050	h8	1807
1.4301/1.4307+AT+SL Ground Round	75	3100	h7	534
1.4301/1.4307+AT+SL Ground Round	75	3100	h7	958
1.4301/1.4307+AT+SL Ground Round	75	3100	h9	525
1.4301/1.4307+AT+SL Ground Round	75	3100	h9	755
1.4301/1.4307+AT+SL Ground Round	75	3100	h9	1720
1.4301/1.4307+AT+SL Ground Round	75	3100	h9	964
1.4301/1.4307+AT+SL Ground Round	85	3050	h8	3259
1.4301/1.4307+AT+SL Ground Round	88,9	3757	ASTMA484	1105
1.4301/1.4307+AT+SL Ground Round	90	3050	h8	1240
1.4301/1.4307+AT+SL Ground Round	90	3100	h8	1854
1.4301/1.4307+AT+SL Ground Round	90	3200	h8	635
1.4301/1.4307+AT+SL Ground Round	90	3200	h8	946
1.4301/1.4307+AT+SL Ground Round	90	3220	h8	628
1.4301/1.4307+AT+SL Ground Round	95	3050	h9	853
1.4301/1.4307+AT+SL Ground Round	100	3050	h8	953
1.4301/1.4307+AT+SL Ground Round	100	3050	h9	1132
1.4301/1.4307+AT+SL Ground Round	100	3100	h7	762
1.4301/1.4307+AT+SL Ground Round	100	3100	h8	952
1.4301/1.4307+C700-2H Cold Drawn Round	22	3050	h11	1868
1.4301/1.4307+C700-2H Cold Drawn Round	22	3050	h11	1004
1.4301/1.4307+C700-2H Cold Drawn Round	22	3050	h11	737
1.4301/1.4307+C800 Cold Drawn Round	16	3050	h9	137

1.4301/1.4307Hot Rolled+AT-1X Rough Machined Round	26	3100	k10	4884
1.4301/1.4307Hot Rolled+AT-1X Rough Machined Round	27	3100	k10	84
1.4301/1.4307Hot Rolled+AT-1X Rough Machined Round	27	3100	k10	900
1.4301/1.4307Hot Rolled+AT-1X Rough Machined Round	27	3100	k10	168
1.4301/1.4307Hot Rolled+AT-1X Rough Machined Round	28	3100	k10	2597
1.4301/1.4307Hot Rolled+AT-1X Rough Machined Round	29	3100	k10	2270
1.4301/1.4307Hot Rolled+AT-1X Rough Machined Round	34	3100	k10	2762
1.4301/1.4307Hot Rolled+AT-1X Rough Machined Round	34	3100	k10	1760
1.4301/1.4307Hot Rolled+AT-1X Rough Machined Round	35	3100	h9	2036
1.4301/1.4307Hot Rolled+AT-1X Rough Machined Round	38	3100	k10	3326
1.4301/1.4307Hot Rolled+AT-1X Rough Machined Round	45	3100	k10	4250
1.4301/1.4307Hot Rolled+AT-1X Rough Machined Round	46	3100	k10	4120
1.4301/1.4307Hot Rolled+AT-1X Rough Machined Round	48	3100	k10	3236
1.4301/1.4307Hot Rolled+AT-1X Rough Machined Round	48	6100	k12	263

1.4301/1.4307 Hot Rolled+AT-1X Rough Machined Round	50	3100	k10	866
1.4301/1.4307 Hot Rolled+AT-1X Rough Machined Round	55	6100	k12	807
1.4301/1.4307 Hot Rolled+AT-1X Rough Machined Round	55	6100	k12	585
1.4301/1.4307 Hot Rolled+AT-1X Rough Machined Round	65	6100	k12	965
1.4301/1.4307 Hot Rolled+AT-1X Rough Machined Round	90	3050	h9	770
1.4301/1.4307 Hot Rolled+AT-1X Rough Machined Round	90	6100	k12	922
1.4305+C700-2H Cold Drawn Round	21	3050	h9	1010
1.4305-AISI 303 Hot Rolled+AT-1X Rough Mach.Round	30	3200	h9	890
1.4305-AISI 303 Hot Rolled+AT-1X Rough Mach.Round	105	3100	k12	1039
1.4305-AISI 303+AT+C-2H Cold Drawn Hexagon	11	3050	h11	686
1.4305-AISI 303+AT+C-2H Cold Drawn Hexagon	12,7	4267	ASTMA484	2191
1.4305-AISI 303+AT+C-2H Cold Drawn Hexagon	13	3050	h11	2370
1.4305-AISI 303+AT+C-2H Cold Drawn Hexagon	13	3050	h11	1004
1.4305-AISI 303+AT+C-2H Cold Drawn Hexagon	13	3050	h11	784
1.4305-AISI 303+AT+C-2H Cold Drawn Hexagon	13	3050	h11	2398
1.4305-AISI 303+AT+C-2H Cold Drawn Hexagon	14	3050	h11	712
1.4305-AISI 303+AT+C-2H Cold Drawn Hexagon	21	3050	h11	1945
1.4305-AISI 303+AT+C-2H Cold Drawn Hexagon	21	3050	h11	2968
1.4305-AISI 303+AT+C-2H Cold Drawn Hexagon	21	3050	h11	2833

1.4305-AISI 303+AT+C-2H Cold Drawn Hexagon	22	3050	h11	1877
1.4305-AISI 303+AT+C-2H Cold Drawn Hexagon	22	3050	h11	604
1.4305-AISI 303+AT+C-2H Cold Drawn Hexagon	22	3050	h11	595
1.4305-AISI 303+AT+C-2H Cold Drawn Hexagon	22	3050	h11	498
1.4305-AISI 303+AT+C-2H Cold Drawn Hexagon	22	3050	h11	845
1.4305-AISI 303+AT+C-2H Cold Drawn Hexagon	22	3050	h11	2660
1.4305-AISI 303+AT+C-2H Cold Drawn Hexagon	22	3050	h11	256
1.4305-AISI 303+AT+C-2H Cold Drawn Hexagon	22	3050	h11	10020
1.4305-AISI 303+AT+C-2H Cold Drawn Hexagon	22	3050	h11	1618
1.4305-AISI 303+AT+C-2H Cold Drawn Hexagon	22	3050	h11	594
1.4305-AISI 303+AT+C-2H Cold Drawn Hexagon	22	3050	h11	554
1.4305-AISI 303+AT+C-2H Cold Drawn Hexagon	22	3050	h11	792
1.4305-AISI 303+AT+C-2H Cold Drawn Hexagon	22	3150	h11	603
1.4305-AISI 303+AT+C-2H Cold Drawn Hexagon	22,225	4267	ASTMA484	1688
1.4305-AISI 303+AT+C-2H Cold Drawn Hexagon	23	3050	h11	942
1.4305-AISI 303+AT+C-2H Cold Drawn Hexagon	27	3050	h11	1026
1.4305-AISI 303+AT+C-2H Cold Drawn Hexagon	27	3050	h11	9072
1.4305-AISI 303+AT+C-2H Cold Drawn Hexagon	27	3050	h11	283
1.4305-AISI 303+AT+C-2H Cold Drawn Hexagon	27	3050	h11	1916
1.4305-AISI 303+AT+C-2H Cold Drawn Hexagon	27	3050	h11	2020
1.4305-AISI 303+AT+C-2H Cold Drawn Hexagon	27	3050	h11	7120
1.4305-AISI 303+AT+C-2H Cold Drawn Hexagon	27	3050	h11	3368
1.4305-AISI 303+AT+C-2H Cold Drawn Hexagon	27	3050	h11	799
1.4305-AISI 303+AT+C-2H Cold Drawn Hexagon	55	3200	h11	2045

1.4305-AISI 303+AT+C-2H Cold Drawn Round	5	3050	h9	410
1.4305-AISI 303+AT+C-2H Cold Drawn Round	6,1	3050	h9	589
1.4305-AISI 303+AT+C-2H Cold Drawn Round	8	1500	h9	133
1.4305-AISI 303+AT+C-2H Cold Drawn Round	8,1	3100	h9	1389
1.4305-AISI 303+AT+C-2H Cold Drawn Round	8,1	3100	h9	428
1.4305-AISI 303+AT+C-2H Cold Drawn Round	9	3050	h9	609
1.4305-AISI 303+AT+C-2H Cold Drawn Round	9,5	3050	h9	90
1.4305-AISI 303+AT+C-2H Cold Drawn Round	9,5	3050	h9	106
1.4305-AISI 303+AT+C-2H Cold Drawn Round	9,97	3050	h8	324
1.4305-AISI 303+AT+C-2H Cold Drawn Round	10	3050	h9	461
1.4305-AISI 303+AT+C-2H Cold Drawn Round	10	3050	h9	489
1.4305-AISI 303+AT+C-2H Cold Drawn Round	10	3050	h9	352
1.4305-AISI 303+AT+C-2H Cold Drawn Round	10	4050	h8	213
1.4305-AISI 303+AT+C-2H Cold Drawn Round	10,1	3050	h9	1580
1.4305-AISI 303+AT+C-2H Cold Drawn Round	10,4	3050	h9	280
1.4305-AISI 303+AT+C-2H Cold Drawn Round	10,5	3050	h9	613
1.4305-AISI 303+AT+C-2H Cold Drawn Round	10,5	3050	h9	419
1.4305-AISI 303+AT+C-2H Cold Drawn Round	10,5	3050	h9	1700
1.4305-AISI 303+AT+C-2H Cold Drawn Round	10,5	3050	h9	1110
1.4305-AISI 303+AT+C-2H Cold Drawn Round	12	3050	h9	122
1.4305-AISI 303+AT+C-2H Cold Drawn Round	12	3050	h9	662
1.4305-AISI 303+AT+C-2H Cold Drawn Round	12,9	3050	h9	159
1.4305-AISI 303+AT+C-2H Cold Drawn Round	14	0	h9	243
1.4305-AISI 303+AT+C-2H Cold Drawn Round	14	4050	h9	1046

1.4305-AISI 303+AT+C-2H Cold Drawn Round	14,5	3050	h9	568
1.4305-AISI 303+AT+C-2H Cold Drawn Round	14,5	3050	h9	3048
1.4305-AISI 303+AT+C-2H Cold Drawn Round	15	3050	h9	382
1.4305-AISI 303+AT+C-2H Cold Drawn Round	15	3050	h9	21
1.4305-AISI 303+AT+C-2H Cold Drawn Round	15,97	3050	h8	190
1.4305-AISI 303+AT+C-2H Cold Drawn Round	15,97	3050	h9	675
1.4305-AISI 303+AT+C-2H Cold Drawn Round	16	3050	h9	615
1.4305-AISI 303+AT+C-2H Cold Drawn Round	16	3050	h9	644
1.4305-AISI 303+AT+C-2H Cold Drawn Round	16	3050	h9	1007
1.4305-AISI 303+AT+C-2H Cold Drawn Round	17	3050	h9	569
1.4305-AISI 303+AT+C-2H Cold Drawn Round	19	3050	h9	1374
1.4305-AISI 303+AT+C-2H Cold Drawn Round	19,5	3100	h9	211
1.4305-AISI 303+AT+C-2H Cold Drawn Round	19,5	4050	h9	433
1.4305-AISI 303+AT+C-2H Cold Drawn Round	19,93	6200	h9	177
1.4305-AISI 303+AT+C-2H Cold Drawn Round	20	3050	h9	1033
1.4305-AISI 303+AT+C-2H Cold Drawn Round	20,5	3050	h9	181
1.4305-AISI 303+AT+C-2H Cold Drawn Round	21	3050	h9	812
1.4305-AISI 303+AT+C-2H Cold Drawn Round	21	3050	h9	442
1.4305-AISI 303+AT+C-2H Cold Drawn Round	23	3050	h9	662
1.4305-AISI 303+AT+C-2H Cold Drawn Round	24	3050	h9	1234
1.4305-AISI 303+AT+C-2H Cold Drawn Round	24	3050	h9	193
1.4305-AISI 303+AT+C-2H Cold Drawn Round	25	3000	h9	170
1.4305-AISI 303+AT+C-2H Cold Drawn Round	25	3050	h9	154
1.4305-AISI 303+AT+C-2H Cold Drawn Round	25	3050	h9	942

1.4305-AISI 303+AT+C-2H Cold Drawn Round	25	3050	h9	1001
1.4305-AISI 303+AT+C-2H Cold Drawn Round	25	3050	h9	860
1.4305-AISI 303+AT+C-2H Cold Drawn Round	25	3050	h9	1082
1.4305-AISI 303+AT+C-2H Cold Drawn Round	25	3050	h9	1026
1.4305-AISI 303+AT+C-2H Cold Drawn Round	25	3100	e10	395
1.4305-AISI 303+AT+C-2H Cold Drawn Round	25	3180	h9	113
1.4305-AISI 303+AT+C-2H Cold Drawn Round	25	3165	h9	61
1.4305-AISI 303+AT+C-2H Cold Drawn Round	26	3050	h10	75
1.4305-AISI 303+AT+C-2H Cold Drawn Round	26	3050	h10	85
1.4305-AISI 303+AT+C-2H Cold Drawn Round	26	3050	h9	4056
1.4305-AISI 303+AT+C-2H Cold Drawn Round	26	3050	h9	277
1.4305-AISI 303+AT+C-2H Cold Drawn Round	26	3050	h9	88
1.4305-AISI 303+AT+C-2H Cold Drawn Round	26	3050	h9	63
1.4305-AISI 303+AT+C-2H Cold Drawn Round	26	3650	h9	120
1.4305-AISI 303+AT+C-2H Cold Drawn Round	27	3050	h8	176
1.4305-AISI 303+AT+C-2H Cold Drawn Round	27	3050	h9	367
1.4305-AISI 303+AT+C-2H Cold Drawn Round	28	3200	h9	327
1.4305-AISI 303+AT+C-2H Cold Drawn Round	28,5	3050	h9	1042
1.4305-AISI 303+AT+C-2H Cold Drawn Round	28,5	3050	h9	152
1.4305-AISI 303+AT+C-2H Cold Drawn Round	29	3050	h9	1847
1.4305-AISI 303+AT+C-2H Cold Drawn Round	29	3050	h9	64
1.4305-AISI 303+AT+C-2H Cold Drawn Round	30	3100	e9	250
1.4305-AISI 303+AT+C-2H Cold Drawn Round	30	6200	h11	69
1.4305-AISI 303+AT+C-2H Cold Drawn Square	9	3050	h11	417

1.4305-AISI 303+AT+C-2H Cold Drawn Square	13	3050	h11	6113
1.4305-AISI 303+AT+C-2H Cold Drawn Square	18	3050	h11	2370
1.4305-AISI 303+AT+C-2H Cold Drawn Square	18	3050	h11	984
1.4305-AISI 303+AT+SH-2B Peeled Reeled Round	23	3050	h9	157
1.4305-AISI 303+AT+SH-2B Peeled Reeled Round	25,12	3050	h9	2124
1.4305-AISI 303+AT+SH-2B Peeled Reeled Round	25,12	6100	h9	1394
1.4305-AISI 303+AT+SH-2B Peeled Reeled Round	26	3100	h9	2522
1.4305-AISI 303+AT+SH-2B Peeled Reeled Round	30	3050	h7	51
1.4305-AISI 303+AT+SH-2B Peeled Reeled Round	30,12	3050	h9	7708
1.4305-AISI 303+AT+SH-2B Peeled Reeled Round	30,12	3050	h9	2064
1.4305-AISI 303+AT+SH-2B Peeled Reeled Round	30,12	3200	h9	1164
1.4305-AISI 303+AT+SH-2B Peeled Reeled Round	30,12	3200	h9	5676
1.4305-AISI 303+AT+SH-2B Peeled Reeled Round	32	3050	h9	230
1.4305-AISI 303+AT+SH-2B Peeled Reeled Round	32	3050	k12	1025
1.4305-AISI 303+AT+SH-2B Peeled Reeled Round	32	3100	h9	825
1.4305-AISI 303+AT+SH-2B Peeled Reeled Round	32,05	6100	h9	306
1.4305-AISI 303+AT+SH-2B Peeled Reeled Round	35	3200	h9	791
1.4305-AISI 303+AT+SH-2B Peeled Reeled Round	35,12	3050	h9	1780
1.4305-AISI 303+AT+SH-2B Peeled Reeled Round	39	2400	h9	129
1.4305-AISI 303+AT+SH-2B Peeled Reeled Round	40	3100	h9	642
1.4305-AISI 303+AT+SH-2B Peeled Reeled Round	40	4200	h9	1790
1.4305-AISI 303+AT+SH-2B Peeled Reeled Round	45	3100	h10	80
1.4305-AISI 303+AT+SH-2B Peeled Reeled Round	45,12	3050	h9	908
1.4305-AISI 303+AT+SH-2B Peeled Reeled Round	48	3050	h9	45

1.4305-AISI 303+AT+SH-2B Peeled Reeled Round	50,12	3050	h9	5524
1.4305-AISI 303+AT+SH-2B Peeled Reeled Round	50,12	3050	h9	2232
1.4305-AISI 303+AT+SH-2B Peeled Reeled Round	53	3200	h9	626
1.4305-AISI 303+AT+SH-2B Peeled Reeled Round	54	3100	h9	225
1.4305-AISI 303+AT+SH-2B Peeled Reeled Round	55,12	3050	h9	1316
1.4305-AISI 303+AT+SH-2B Peeled Reeled Round	60	3100	h9	67
1.4305-AISI 303+AT+SH-2B Peeled Reeled Round	60,325	4267	ASTMA484	1566
1.4305-AISI 303+AT+SH-2B Peeled Reeled Round	62	3100	h10	1176
1.4305-AISI 303+AT+SH-2B Peeled Reeled Round	65	3100	h9	810
1.4305-AISI 303+AT+SH-2B Peeled Reeled Round	65,12	3050	h9	1513
1.4305-AISI 303+AT+SH-2B Peeled Reeled Round	65,12	3050	h9	719
1.4305-AISI 303+AT+SH-2B Peeled Reeled Round	70,12	3050	h9	4678
1.4305-AISI 303+AT+SH-2B Peeled Reeled Round	75,12	3050	h9	3382
1.4305-AISI 303+AT+SH-2B Peeled Reeled Round	78	3100	h9	458
1.4305-AISI 303+AT+SH-2B Peeled Reeled Round	80,12	3050	h9	1320
1.4305-AISI 303+AT+SH-2B Peeled Reeled Round	85,12	3050	h9	547
1.4305-AISI 303+AT+SH-2B Peeled Reeled Round	85,12	3050	h9	1353
1.4305-AISI 303+AT+SH-2B Peeled Reeled Round	90,12	3050	h9	3501
1.4305-AISI 303+AT+SL Ground Round	5,5	3050	h8	935
1.4305-AISI 303+AT+SL Ground Round	5,96	3050	h8	298
1.4305-AISI 303+AT+SL Ground Round	6	3050	h8	492
1.4305-AISI 303+AT+SL Ground Round	6	3050	h8	585
1.4305-AISI 303+AT+SL Ground Round	6	3180	h9	284
1.4305-AISI 303+AT+SL Ground Round	6	3120	h7	739

1.4305-AISI 303+AT+SL Ground Round	6,35	3050	h8	607
1.4305-AISI 303+AT+SL Ground Round	7	3050	h6	481
1.4305-AISI 303+AT+SL Ground Round	7,12	3050	h8	311
1.4305-AISI 303+AT+SL Ground Round	8	1530	h8	482
1.4305-AISI 303+AT+SL Ground Round	8	1530	h8	363
1.4305-AISI 303+AT+SL Ground Round	8	3200	h8	502
1.4305-AISI 303+AT+SL Ground Round	8	3200	h8	767
1.4305-AISI 303+AT+SL Ground Round	8	3050	h6	1249
1.4305-AISI 303+AT+SL Ground Round	8	3050	h8	917
1.4305-AISI 303+AT+SL Ground Round	8	3050	h8	243
1.4305-AISI 303+AT+SL Ground Round	8	3050	h8	240
1.4305-AISI 303+AT+SL Ground Round	8	3050	h8	177
1.4305-AISI 303+AT+SL Ground Round	8	3050	h8	855
1.4305-AISI 303+AT+SL Ground Round	8	3050	h8	94
1.4305-AISI 303+AT+SL Ground Round	8	3050	h8	8545
1.4305-AISI 303+AT+SL Ground Round	8	3050	h8	1860
1.4305-AISI 303+AT+SL Ground Round	8	3050	h8	550
1.4305-AISI 303+AT+SL Ground Round	8	3050	h8	426
1.4305-AISI 303+AT+SL Ground Round	8	3150	h9	232
1.4305-AISI 303+AT+SL Ground Round	8	4050	h8	456
1.4305-AISI 303+AT+SL Ground Round	8	6100	h6	424
1.4305-AISI 303+AT+SL Ground Round	9,5	3050	h8	667
1.4305-AISI 303+AT+SL Ground Round	9,5	3050	h8	319
1.4305-AISI 303+AT+SL Ground Round	10	3200	h9	521

1.4305-AISI 303+AT+SL Ground Round	10	3200	h9	177
1.4305-AISI 303+AT+SL Ground Round	10	3050	f8	490
1.4305-AISI 303+AT+SL Ground Round	10	3050	h6	626
1.4305-AISI 303+AT+SL Ground Round	10	3050	h8	320
1.4305-AISI 303+AT+SL Ground Round	10	3050	h8	1174
1.4305-AISI 303+AT+SL Ground Round	10	3050	h8	366
1.4305-AISI 303+AT+SL Ground Round	10	3050	h8	271
1.4305-AISI 303+AT+SL Ground Round	10	3050	h8	228
1.4305-AISI 303+AT+SL Ground Round	10	3050	h8	224
1.4305-AISI 303+AT+SL Ground Round	10	3050	h8	539
1.4305-AISI 303+AT+SL Ground Round	10	3050	h8	1089
1.4305-AISI 303+AT+SL Ground Round	10	3050	h8	214
1.4305-AISI 303+AT+SL Ground Round	10	3050	h8	261
1.4305-AISI 303+AT+SL Ground Round	10	3050	h8	901
1.4305-AISI 303+AT+SL Ground Round	10	3050	h8	950
1.4305-AISI 303+AT+SL Ground Round	10	3050	h8	391
1.4305-AISI 303+AT+SL Ground Round	10	3050	h8	416
1.4305-AISI 303+AT+SL Ground Round	10	3050	h8	629
1.4305-AISI 303+AT+SL Ground Round	10	3050	h8	216
1.4305-AISI 303+AT+SL Ground Round	10	3050	h9	104
1.4305-AISI 303+AT+SL Ground Round	10	3050	h9	173
1.4305-AISI 303+AT+SL Ground Round	10	3050	h9	110
1.4305-AISI 303+AT+SL Ground Round	10	3050	h9	844
1.4305-AISI 303+AT+SL Ground Round	10	3100	h8	726

1.4305-AISI 303+AT+SL Ground Round	10	3120	h9	3940
1.4305-AISI 303+AT+SL Ground Round	10	3150	h8	360
1.4305-AISI 303+AT+SL Ground Round	10	3150	h8	220
1.4305-AISI 303+AT+SL Ground Round	10	3150	h8	409
1.4305-AISI 303+AT+SL Ground Round	10	3150	h8	69
1.4305-AISI 303+AT+SL Ground Round	10	3150	h8	542
1.4305-AISI 303+AT+SL Ground Round	10	3180	h8	4164
1.4305-AISI 303+AT+SL Ground Round	10	3180	h8	4126
1.4305-AISI 303+AT+SL Ground Round	10	3120	h8	1164
1.4305-AISI 303+AT+SL Ground Round	10	3120	h8	357
1.4305-AISI 303+AT+SL Ground Round	10	3120	h8	690
1.4305-AISI 303+AT+SL Ground Round	10	3120	h8	402
1.4305-AISI 303+AT+SL Ground Round	10	3120	h8	300
1.4305-AISI 303+AT+SL Ground Round	10	3120	h8	722
1.4305-AISI 303+AT+SL Ground Round	10	3120	h8	722
1.4305-AISI 303+AT+SL Ground Round	10	3120	h9	290
1.4305-AISI 303+AT+SL Ground Round	10	3120	h9	2999
1.4305-AISI 303+AT+SL Ground Round	10	3120	h9	105
1.4305-AISI 303+AT+SL Ground Round	10	3150	h8	612
1.4305-AISI 303+AT+SL Ground Round	10	3150	h8	280
1.4305-AISI 303+AT+SL Ground Round	10	3150	h8	4708
1.4305-AISI 303+AT+SL Ground Round	10	3150	h8	1300
1.4305-AISI 303+AT+SL Ground Round	10	3150	h8	331
1.4305-AISI 303+AT+SL Ground Round	10	3180	h8	1676

1.4305-AISI 303+AT+SL Ground Round	10	3180	h9	607
1.4305-AISI 303+AT+SL Ground Round	10	4050	h8	314
1.4305-AISI 303+AT+SL Ground Round	10	4050	h8	700
1.4305-AISI 303+AT+SL Ground Round	10	6100	h8	389
1.4305-AISI 303+AT+SL Ground Round	11	3050	h9	194
1.4305-AISI 303+AT+SL Ground Round	11,26	3050	h8	330
1.4305-AISI 303+AT+SL Ground Round	11,26	3050	h8	456
1.4305-AISI 303+AT+SL Ground Round	11,95	3180	h8	346
1.4305-AISI 303+AT+SL Ground Round	12	3050	h7	496
1.4305-AISI 303+AT+SL Ground Round	12	3050	h8	7616
1.4305-AISI 303+AT+SL Ground Round	12	3050	h8	256
1.4305-AISI 303+AT+SL Ground Round	12	3050	h8	492
1.4305-AISI 303+AT+SL Ground Round	12	4050	h8	771
1.4305-AISI 303+AT+SL Ground Round	12	4050	h8	464
1.4305-AISI 303+AT+SL Ground Round	12	4050	h8	1293
1.4305-AISI 303+AT+SL Ground Round	12	4050	h8	1057
1.4305-AISI 303+AT+SL Ground Round	12	4050	h8	286
1.4305-AISI 303+AT+SL Ground Round	12	4050	h8	315
1.4305-AISI 303+AT+SL Ground Round	12	4050	h8	210
1.4305-AISI 303+AT+SL Ground Round	12	4050	h8	1573
1.4305-AISI 303+AT+SL Ground Round	12	4050	h8	2179
1.4305-AISI 303+AT+SL Ground Round	12	4050	h8	1351
1.4305-AISI 303+AT+SL Ground Round	12	4050	h8	260
1.4305-AISI 303+AT+SL Ground Round	12,5	3050	h8	211

1.4305-AISI 303+AT+SL Ground Round	13	3050	h6	324
1.4305-AISI 303+AT+SL Ground Round	13	3050	h8	290
1.4305-AISI 303+AT+SL Ground Round	13,47	3050	h8	426
1.4305-AISI 303+AT+SL Ground Round	14	2700	h8	923
1.4305-AISI 303+AT+SL Ground Round	14	3050	h8	196
1.4305-AISI 303+AT+SL Ground Round	14	3050	h8	171
1.4305-AISI 303+AT+SL Ground Round	14	3050	h8	740
1.4305-AISI 303+AT+SL Ground Round	14	3050	h8	262
1.4305-AISI 303+AT+SL Ground Round	14	3100	h9	1219
1.4305-AISI 303+AT+SL Ground Round	14	3100	h9	488
1.4305-AISI 303+AT+SL Ground Round	15	3050	h7	232
1.4305-AISI 303+AT+SL Ground Round	15	3050	h8	688
1.4305-AISI 303+AT+SL Ground Round	15	3050	h8	470
1.4305-AISI 303+AT+SL Ground Round	15	3050	h8	185
1.4305-AISI 303+AT+SL Ground Round	15	3050	h8	1064
1.4305-AISI 303+AT+SL Ground Round	15	3050	h8	2915
1.4305-AISI 303+AT+SL Ground Round	15	6050	h8	200
1.4305-AISI 303+AT+SL Ground Round	16	3050	h6	561
1.4305-AISI 303+AT+SL Ground Round	16	3050	h9	516
1.4305-AISI 303+AT+SL Ground Round	18	3050	h9	494
1.4305-AISI 303+AT+SL Ground Round	18	3200	h8	192
1.4305-AISI 303+AT+SL Ground Round	18,97	3050	h8	375
1.4305-AISI 303+AT+SL Ground Round	18,97	3050	h8	220
1.4305-AISI 303+AT+SL Ground Round	18,97	3050	h8	206

1.4305-AISI 303+AT+SL Ground Round	20	3200	h8	477
1.4305-AISI 303+AT+SL Ground Round	20	3200	h9	119
1.4305-AISI 303+AT+SL Ground Round	20	3050	h11	5221
1.4305-AISI 303+AT+SL Ground Round	20	3050	h11	891
1.4305-AISI 303+AT+SL Ground Round	20	3050	h7	368
1.4305-AISI 303+AT+SL Ground Round	20	3050	h8	1875
1.4305-AISI 303+AT+SL Ground Round	20	3050	h8	2699
1.4305-AISI 303+AT+SL Ground Round	20	3050	h8	697
1.4305-AISI 303+AT+SL Ground Round	20	3100	h8	75
1.4305-AISI 303+AT+SL Ground Round	20	3100	h8	270
1.4305-AISI 303+AT+SL Ground Round	20	3180	h8	178
1.4305-AISI 303+AT+SL Ground Round	23	3050	h9	760
1.4305-AISI 303+AT+SL Ground Round	23	3050	h9	316
1.4305-AISI 303+AT+SL Ground Round	24,94	3050	h8	200
1.4305-AISI 303+AT+SL Ground Round	24,94	6050	h9	93
1.4305-AISI 303+AT+SL Ground Round	25	3000	h8	137
1.4305-AISI 303+AT+SL Ground Round	25	3000	h8	341
1.4305-AISI 303+AT+SL Ground Round	25	3000	h9	103
1.4305-AISI 303+AT+SL Ground Round	25	3050	h8	374
1.4305-AISI 303+AT+SL Ground Round	25	3050	h8	2814
1.4305-AISI 303+AT+SL Ground Round	25	3050	h8	2818
1.4305-AISI 303+AT+SL Ground Round	25	3050	h8	1876
1.4305-AISI 303+AT+SL Ground Round	25	3050	h8	8086
1.4305-AISI 303+AT+SL Ground Round	25	3050	h9	1026

1.4305-AISI 303+AT+SL Ground Round	25	3050	h9	969
1.4305-AISI 303+AT+SL Ground Round	25	3050	h9	35
1.4305-AISI 303+AT+SL Ground Round	25	3060	h8	502
1.4305-AISI 303+AT+SL Ground Round	25	3090	h8	942
1.4305-AISI 303+AT+SL Ground Round	25	3100	h8	1400
1.4305-AISI 303+AT+SL Ground Round	25	3100	h8	942
1.4305-AISI 303+AT+SL Ground Round	25	3100	h8	940
1.4305-AISI 303+AT+SL Ground Round	25	3100	h9	306
1.4305-AISI 303+AT+SL Ground Round	25	3100	h9	4484
1.4305-AISI 303+AT+SL Ground Round	25	3150	h8	444
1.4305-AISI 303+AT+SL Ground Round	25	3150	h8	480
1.4305-AISI 303+AT+SL Ground Round	25	3180	h8	432
1.4305-AISI 303+AT+SL Ground Round	25	3180	h8	61
1.4305-AISI 303+AT+SL Ground Round	25	3180	h9	133
1.4305-AISI 303+AT+SL Ground Round	25	3120	h8	313
1.4305-AISI 303+AT+SL Ground Round	25	3120	h8	624
1.4305-AISI 303+AT+SL Ground Round	25	3120	h8	372
1.4305-AISI 303+AT+SL Ground Round	25	3120	h8	456
1.4305-AISI 303+AT+SL Ground Round	25	3120	h8	348
1.4305-AISI 303+AT+SL Ground Round	25	3120	h8	336
1.4305-AISI 303+AT+SL Ground Round	25	3165	h8	495
1.4305-AISI 303+AT+SL Ground Round	25	3165	h8	290
1.4305-AISI 303+AT+SL Ground Round	25	3165	h8	352
1.4305-AISI 303+AT+SL Ground Round	25	3165	h8	422

1.4305-AISI 303+AT+SL Ground Round	25	3165	h8	425
1.4305-AISI 303+AT+SL Ground Round	25	3165	h8	777
1.4305-AISI 303+AT+SL Ground Round	25	3165	h8	387
1.4305-AISI 303+AT+SL Ground Round	25	3165	h8	1017
1.4305-AISI 303+AT+SL Ground Round	25	3165	h8	387
1.4305-AISI 303+AT+SL Ground Round	25	3165	h8	2359
1.4305-AISI 303+AT+SL Ground Round	25	3165	h8	230
1.4305-AISI 303+AT+SL Ground Round	25	3165	h8	1781
1.4305-AISI 303+AT+SL Ground Round	25	6050	h8	764
1.4305-AISI 303+AT+SL Ground Round	25	6050	h8	604
1.4305-AISI 303+AT+SL Ground Round	26	3050	h8	924
1.4305-AISI 303+AT+SL Ground Round	26	3050	h8	593
1.4305-AISI 303+AT+SL Ground Round	26	3050	h9	152
1.4305-AISI 303+AT+SL Ground Round	26	3100	h9	902
1.4305-AISI 303+AT+SL Ground Round	26	3100	h9	3426
1.4305-AISI 303+AT+SL Ground Round	26	3100	h9	902
1.4305-AISI 303+AT+SL Ground Round	28	3050	h8	580
1.4305-AISI 303+AT+SL Ground Round	28	3050	h8	764
1.4305-AISI 303+AT+SL Ground Round	28	3050	h8	744
1.4305-AISI 303+AT+SL Ground Round	28	3050	h9	410
1.4305-AISI 303+AT+SL Ground Round	28	3050	h9	846
1.4305-AISI 303+AT+SL Ground Round	28	3650	h8	158
1.4305-AISI 303+AT+SL Ground Round	30	3050	h8	1133
1.4305-AISI 303+AT+SL Ground Round	30	3050	h8	4120

1.4305-AISI 303+AT+SL Ground Round	30	3050	h9	900
1.4305-AISI 303+AT+SL Ground Round	30	3050	h9	3020
1.4305-AISI 303+AT+SL Ground Round	30	3100	h8	480
1.4305-AISI 303+AT+SL Ground Round	30	3100	h9	17
1.4305-AISI 303+AT+SL Ground Round	30	3200	h7	2220
1.4305-AISI 303+AT+SL Ground Round	30	4100	h8	137
1.4305-AISI 303+AT+SL Ground Round	31,75	3757	ASTMA484	558
1.4305-AISI 303+AT+SL Ground Round	33	3200	h9	983
1.4305-AISI 303+AT+SL Ground Round	35	3050	h7	484
1.4305-AISI 303+AT+SL Ground Round	36	3050	h8	2682
1.4305-AISI 303+AT+SL Ground Round	36	3100	h9	3310
1.4305-AISI 303+AT+SL Ground Round	38	3050	h8	1222
1.4305-AISI 303+AT+SL Ground Round	38	3050	h8	2322
1.4305-AISI 303+AT+SL Ground Round	38	3100	h9	4104
1.4305-AISI 303+AT+SL Ground Round	39,92	6200	h8	358
1.4305-AISI 303+AT+SL Ground Round	40	3050	h9	30
1.4305-AISI 303+AT+SL Ground Round	40	3100	h10	30
1.4305-AISI 303+AT+SL Ground Round	40	3100	h7	924
1.4305-AISI 303+AT+SL Ground Round	40	3100	h8	34
1.4305-AISI 303+AT+SL Ground Round	40	4200	h9	161
1.4305-AISI 303+AT+SL Ground Round	40	6100	h8	1074
1.4305-AISI 303+AT+SL Ground Round	40	6100	h9	120
1.4305-AISI 303+AT+SL Ground Round	42	3050	h8	1134
1.4305-AISI 303+AT+SL Ground Round	42	3050	h8	444

1.4305-AISI 303+AT+SL Ground Round	42	3050	h8	1193
1.4305-AISI 303+AT+SL Ground Round	45	3100	h8	382
1.4305-AISI 303+AT+SL Ground Round	45	3100	h8	76
1.4305-AISI 303+AT+SL Ground Round	45	3100	h8	1359
1.4305-AISI 303+AT+SL Ground Round	45	3100	h8	687
1.4305-AISI 303+AT+SL Ground Round	45	3100	h9	3363
1.4305-AISI 303+AT+SL Ground Round	45	3100	h9	772
1.4305-AISI 303+AT+SL Ground Round	48	3100	h9	3510
1.4305-AISI 303+AT+SL Ground Round	49,92	6100	h8	186
1.4305-AISI 303+AT+SL Ground Round	50	3100	h9	2108
1.4305-AISI 303+AT+SL Ground Round	50	3100	h9	423
1.4305-AISI 303+AT+SL Ground Round	52	3100	h9	1022
1.4305-AISI 303+AT+SL Ground Round	55	3100	h9	634
1.4305-AISI 303+AT+SL Ground Round	55	3100	h9	1673
1.4305-AISI 303+AT+SL Ground Round	55	3100	h9	56
1.4305-AISI 303+AT+SL Ground Round	55	3100	h9	1726
1.4305-AISI 303+AT+SL Ground Round	57	3050	h8	3055
1.4305-AISI 303+AT+SL Ground Round	57	3100	h8	1161
1.4305-AISI 303+AT+SL Ground Round	60	3050	h8	606
1.4305-AISI 303+AT+SL Ground Round	60	3100	h10	6253
1.4305-AISI 303+AT+SL Ground Round	60	3100	h6	140
1.4305-AISI 303+AT+SL Ground Round	60	3100	h8	67
1.4305-AISI 303+AT+SL Ground Round	60	3100	h9	484
1.4305-AISI 303+AT+SL Ground Round	65	3050	h8	403

1.4305-AISI 303+AT+SL Ground Round	65	3050	h8	3175
1.4305-AISI 303+AT+SL Ground Round	65	3100	h9	1617
1.4305-AISI 303+AT+SL Ground Round	65	3100	h9	5036
1.4305-AISI 303+AT+SL Ground Round	70	3050	h8	2404
1.4305-AISI 303+AT+SL Ground Round	70	3050	h8	1476
1.4305-AISI 303+AT+SL Ground Round	70	3100	h10	6614
1.4305-AISI 303+AT+SL Ground Round	70	3100	h10	4462
1.4305-AISI 303+AT+SL Ground Round	70	3100	h10	744
1.4305-AISI 303+AT+SL Ground Round	70	3100	h9	1666
1.4305-AISI 303+AT+SL Ground Round	70	3100	h9	746
1.4305-AISI 303+AT+SL Ground Round	75	3050	h8	1692
1.4305-AISI 303+AT+SL Ground Round	75	6100	h8	3124
1.4305-AISI 303+AT+SL Ground Round	80	3050	h8	2875
1.4305-AISI 303+AT+SL Ground Round	80	3050	h9	1667
1.4305-AISI 303+AT+SL Ground Round	80	3050	h9	726
1.4305-AISI 303+AT+SL Ground Round	80	3100	h9	1208
1.4305-AISI 303+AT+SL Ground Round	85	3050	h8	542
1.4305-AISI 303+AT+SL Ground Round	85	3050	h8	542
1.4305-AISI 303+AT+SL Ground Round	85	3050	h9	680
1.4305-AISI 303+AT+SL Ground Round	90	3050	h8	2429
1.4305-AISI 303+AT+SL Ground Round	100	3050	h8	557
1.4305-AISI 303+AT+SL Ground Round	100	3050	h8	2053
1.4305-AISI 303+AT+SL Ground Round	100	3100	h9	933
1.4404 +C800 Cold Drawn Hexagon	10	3050	h11	2150

1.4404 +C800 Cold Drawn Round	14,56	3050	h9	262
1.4404 +C800 Cold Drawn Round	14,56	3050	h9	210
1.4404 +C800 Cold Drawn Round	15,875	3050	h9	95
1.4404-AISI 316L Hot Roll.+AT-1X Rough Mach. Round	20	6100	k12	799
1.4404-AISI 316L Hot Roll.+AT-1X Rough Mach. Round	22	3100	h9	1791
1.4404-AISI 316L Hot Roll.+AT-1X Rough Mach. Round	26	3100	k10	3274
1.4404-AISI 316L Hot Roll.+AT-1X Rough Mach. Round	28	6100	k12	561
1.4404-AISI 316L Hot Roll.+AT-1X Rough Mach. Round	30	3100	h9	1856
1.4404-AISI 316L Hot Roll.+AT-1X Rough Mach. Round	40	6100	k12	490
1.4404-AISI 316L Hot Roll.+AT-1X Rough Mach. Round	50	3100	h9	1742
1.4404-AISI 316L Hot Roll.+AT-1X Rough Mach. Round	75	3100	k12	541
1.4404-AISI 316L Hot Roll.+AT-1X Rough Mach. Round	75	3100	k12	966
1.4404-AISI 316L Hot Roll.+AT-1X Rough Mach. Round	90	6100	k12	1234
1.4404-AISI 316L Hot Roll.+AT-1X Rough Mach. Round	110	6200	k12	919
1.4404-AISI 316L Hot Roll.+AT-1X Rough Mach. Round	130	6000	k12	1134

1.4404-AISI 316L Hot Roll.+AT-1X Rough Mach. Round	140	6200	k12	1500
1.4404-AISI 316L Hot Roll.+AT-1X Rough Mach. Round	145	6100	k12	1610
1.4404-AISI 316L+AT+C Cold Drawn Square	9,525	3708	ASTMA484	2778
1.4404-AISI 316L+AT+C-2H Cold Drawn Flat	14	3050	h11	509
1.4404-AISI 316L+AT+C-2H Cold Drawn Hexagon	9	3050	h11	897
1.4404-AISI 316L+AT+C-2H Cold Drawn Hexagon	10	3050	h11	947
1.4404-AISI 316L+AT+C-2H Cold Drawn Hexagon	11	3050	h11	825
1.4404-AISI 316L+AT+C-2H Cold Drawn Hexagon	14	3050	h11	1057
1.4404-AISI 316L+AT+C-2H Cold Drawn Hexagon	18	3050	h11	1743
1.4404-AISI 316L+AT+C-2H Cold Drawn Hexagon	19	3050	h11	1002
1.4404-AISI 316L+AT+C-2H Cold Drawn Hexagon	19	3050	h11	837
1.4404-AISI 316L+AT+C-2H Cold Drawn Hexagon	24	3050	h11	1217
1.4404-AISI 316L+AT+C-2H Cold Drawn Round	7,1	3050	h9	2741
1.4404-AISI 316L+AT+C-2H Cold Drawn Round	8,1	3050	h9	884
1.4404-AISI 316L+AT+C-2H Cold Drawn Round	9,28	3500	h9	143
1.4404-AISI 316L+AT+C-2H Cold Drawn Round	10,4	3050	h9	131
1.4404-AISI 316L+AT+C-2H Cold Drawn Round	12	3050	h9	225
1.4404-AISI 316L+AT+C-2H Cold Drawn Round	12	3050	h9	330
1.4404-AISI 316L+AT+C-2H Cold Drawn Round	12,7	3050	h9	485
1.4404-AISI 316L+AT+C-2H Cold Drawn Round	14	3050	h9	871
1.4404-AISI 316L+AT+C-2H Cold Drawn Round	14	3050	h9	830
1.4404-AISI 316L+AT+C-2H Cold Drawn Round	14	3050	h9	398

1.4404-AISI 316L+AT+C-2H Cold Drawn Round	14	4100	h9	938
1.4404-AISI 316L+AT+C-2H Cold Drawn Round	14	4100	h9	1013
1.4404-AISI 316L+AT+C-2H Cold Drawn Round	14	4100	h9	3185
1.4404-AISI 316L+AT+C-2H Cold Drawn Round	14,1	3050	h9	966
1.4404-AISI 316L+AT+C-2H Cold Drawn Round	14,5	6050	h9	678
1.4404-AISI 316L+AT+C-2H Cold Drawn Round	14,55	3050	h9	1071
1.4404-AISI 316L+AT+C-2H Cold Drawn Round	14,6	3050	h9	540
1.4404-AISI 316L+AT+C-2H Cold Drawn Round	17,7	3050	h9	285
1.4404-AISI 316L+AT+C-2H Cold Drawn Round	18	3050	h9	1022
1.4404-AISI 316L+AT+C-2H Cold Drawn Round	18,25	6050	h9	962
1.4404-AISI 316L+AT+C-2H Cold Drawn Round	19	3050	h9	722
1.4404-AISI 316L+AT+C-2H Cold Drawn Round	19	3050	h9	1984
1.4404-AISI 316L+AT+C-2H Cold Drawn Round	21,92	6050	h9	1027
1.4404-AISI 316L+AT+C-2H Cold Drawn Round	22	3050	h9	531
1.4404-AISI 316L+AT+C-2H Cold Drawn Round	24	6000	h9	65
1.4404-AISI 316L+AT+C-2H Cold Drawn Round	24,95	3050	h9	247
1.4404-AISI 316L+AT+C-2H Cold Drawn Round	25	3050	h9	189
1.4404-AISI 316L+AT+C-2H Cold Drawn Round	25,08	6100	h9	1314
1.4404-AISI 316L+AT+C-2H Cold Drawn Round	26,75	6150	h9	1084
1.4404-AISI 316L+AT+C-2H Cold Drawn Round	30	3050	h9	951
1.4404-AISI 316L+AT+SH-2B Peeled Reeled Round	30,12	3050	h9	940
1.4404-AISI 316L+AT+SH-2B Peeled Reeled Round	35	3050	h9	280
1.4404-AISI 316L+AT+SH-2B Peeled Reeled Round	35	3100	h9	774
1.4404-AISI 316L+AT+SH-2B Peeled Reeled Round	35	3100	h9	70

1.4404-AISI 316L+AT+SH-2B Peeled Reeled Round	35,12	3050	h9	4030
1.4404-AISI 316L+AT+SH-2B Peeled Reeled Round	36	3100	h9	1016
1.4404-AISI 316L+AT+SH-2B Peeled Reeled Round	69,85	4267	ASTMA484	1118
1.4404-AISI 316L+AT+SH-2B Peeled Reeled Round	70,12	3050	h9	3376
1.4404-AISI 316L+AT+SH-2B Peeled Reeled Round	70,12	3050	h9	1155
1.4404-AISI 316L+AT+SH-2B Peeled Reeled Round	70,12	3050	h9	651
1.4404-AISI 316L+AT+SH-2B Peeled Reeled Round	70,12	3050	h9	1312
1.4404-AISI 316L+AT+SH-2B Peeled Reeled Round	70,12	3050	h9	187
1.4404-AISI 316L+AT+SH-2B Peeled Reeled Round	75,12	3050	h9	4601
1.4404-AISI 316L+AT+SH-2B Peeled Reeled Round	85,12	3050	h9	1939
1.4404-AISI 316L+AT+SH-2B Peeled Reeled Round	85,12	3050	h9	969
1.4404-AISI 316L+AT+SH-2B Peeled Reeled Round	85,12	3100	h9	831
1.4404-AISI 316L+AT+SL Ground Round	3	3050	h8	976
1.4404-AISI 316L+AT+SL Ground Round	4	3050	h8	1595
1.4404-AISI 316L+AT+SL Ground Round	5	3050	h8	1566
1.4404-AISI 316L+AT+SL Ground Round	6	3050	h8	500
1.4404-AISI 316L+AT+SL Ground Round	6	3050	h8	1122
1.4404-AISI 316L+AT+SL Ground Round	6,21	3050	h6	3525
1.4404-AISI 316L+AT+SL Ground Round	7	3050	h9	999
1.4404-AISI 316L+AT+SL Ground Round	7	3050	h9	467
1.4404-AISI 316L+AT+SL Ground Round	8	3200	h9	254
1.4404-AISI 316L+AT+SL Ground Round	8	3050	h8	1221
1.4404-AISI 316L+AT+SL Ground Round	8	3050	h9	839
1.4404-AISI 316L+AT+SL Ground Round	8	3050	h9	398

1.4404-AISI 316L+AT+SL Ground Round	9	3050	h8	183
1.4404-AISI 316L+AT+SL Ground Round	9	3050	h9	483
1.4404-AISI 316L+AT+SL Ground Round	10	3050	h9	785
1.4404-AISI 316L+AT+SL Ground Round	12	3050	h8	995
1.4404-AISI 316L+AT+SL Ground Round	12	3050	h8	991
1.4404-AISI 316L+AT+SL Ground Round	12	3050	h8	538
1.4404-AISI 316L+AT+SL Ground Round	12	3050	h8	2104
1.4404-AISI 316L+AT+SL Ground Round	12	3050	h8	955
1.4404-AISI 316L+AT+SL Ground Round	12	6000	h8	213
1.4404-AISI 316L+AT+SL Ground Round	12	6000	h8	380
1.4404-AISI 316L+AT+SL Ground Round	14	3050	h6	1072
1.4404-AISI 316L+AT+SL Ground Round	14	3050	h8	1860
1.4404-AISI 316L+AT+SL Ground Round	14	3050	h8	1050
1.4404-AISI 316L+AT+SL Ground Round	14	3050	h8	849
1.4404-AISI 316L+AT+SL Ground Round	14	3050	h8	434
1.4404-AISI 316L+AT+SL Ground Round	14	3050	h8	641
1.4404-AISI 316L+AT+SL Ground Round	14	3050	h8	320
1.4404-AISI 316L+AT+SL Ground Round	14	3050	h8	289
1.4404-AISI 316L+AT+SL Ground Round	14	3050	h8	805
1.4404-AISI 316L+AT+SL Ground Round	14	3050	h8	446
1.4404-AISI 316L+AT+SL Ground Round	14	3050	h9	353
1.4404-AISI 316L+AT+SL Ground Round	14	3050	h9	1000
1.4404-AISI 316L+AT+SL Ground Round	14	3100	h8	266
1.4404-AISI 316L+AT+SL Ground Round	14	3100	h8	455

1.4404-AISI 316L+AT+SL Ground Round	15	3050	h8	1384
1.4404-AISI 316L+AT+SL Ground Round	15	3050	h8	1290
1.4404-AISI 316L+AT+SL Ground Round	15	3050	h8	606
1.4404-AISI 316L+AT+SL Ground Round	15	3050	h8	208
1.4404-AISI 316L+AT+SL Ground Round	15	3100	h8	846
1.4404-AISI 316L+AT+SL Ground Round	16	3050	h9	1012
1.4404-AISI 316L+AT+SL Ground Round	16	3050	h9	1096
1.4404-AISI 316L+AT+SL Ground Round	17	3050	h8	1413
1.4404-AISI 316L+AT+SL Ground Round	18	3050	h8	141
1.4404-AISI 316L+AT+SL Ground Round	18	3050	h9	294
1.4404-AISI 316L+AT+SL Ground Round	18	3050	h9	479
1.4404-AISI 316L+AT+SL Ground Round	19	3050	h8	2333
1.4404-AISI 316L+AT+SL Ground Round	20	3100	h8	293
1.4404-AISI 316L+AT+SL Ground Round	20	3100	h8	490
1.4404-AISI 316L+AT+SL Ground Round	20	3100	h8	565
1.4404-AISI 316L+AT+SL Ground Round	20	4050	h9	784
1.4404-AISI 316L+AT+SL Ground Round	20,15	3050	h9	200
1.4404-AISI 316L+AT+SL Ground Round	22	3100	h8	1974
1.4404-AISI 316L+AT+SL Ground Round	24	3050	h8	2912
1.4404-AISI 316L+AT+SL Ground Round	25	3050	h8	966
1.4404-AISI 316L+AT+SL Ground Round	25	3050	h8	1730
1.4404-AISI 316L+AT+SL Ground Round	25	3050	h8	1970
1.4404-AISI 316L+AT+SL Ground Round	25	3050	h8	2218
1.4404-AISI 316L+AT+SL Ground Round	25	3050	h9	1026

1.4404-AISI 316L+AT+SL Ground Round	25	3100	h8	1246
1.4404-AISI 316L+AT+SL Ground Round	25	6050	h8	542
1.4404-AISI 316L+AT+SL Ground Round	25	6050	h8	610
1.4404-AISI 316L+AT+SL Ground Round	25	6050	h9	754
1.4404-AISI 316L+AT+SL Ground Round	25	6050	h9	707
1.4404-AISI 316L+AT+SL Ground Round	25	6100	h8	260
1.4404-AISI 316L+AT+SL Ground Round	25	6100	h8	493
1.4404-AISI 316L+AT+SL Ground Round	25	6100	h8	871
1.4404-AISI 316L+AT+SL Ground Round	25	6200	h9	1145
1.4404-AISI 316L+AT+SL Ground Round	26	3050	h8	426
1.4404-AISI 316L+AT+SL Ground Round	26	3050	h8	925
1.4404-AISI 316L+AT+SL Ground Round	28	3050	h8	972
1.4404-AISI 316L+AT+SL Ground Round	28	3050	h8	1774
1.4404-AISI 316L+AT+SL Ground Round	28	3050	h8	549
1.4404-AISI 316L+AT+SL Ground Round	30	3050	h8	848
1.4404-AISI 316L+AT+SL Ground Round	30	3100	h9	274
1.4404-AISI 316L+AT+SL Ground Round	30	3100	h9	240
1.4404-AISI 316L+AT+SL Ground Round	32	3060	h8	974
1.4404-AISI 316L+AT+SL Ground Round	32	3080	h8	1538
1.4404-AISI 316L+AT+SL Ground Round	35	3050	h8	1082
1.4404-AISI 316L+AT+SL Ground Round	35	3100	h8	1468
1.4404-AISI 316L+AT+SL Ground Round	35	3100	h9	1882
1.4404-AISI 316L+AT+SL Ground Round	35	3100	h9	893
1.4404-AISI 316L+AT+SL Ground Round	36	3050	h8	1354

1.4404-AISI 316L+AT+SL Ground Round	36	3050	h8	420
1.4404-AISI 316L+AT+SL Ground Round	36	3050	h8	948
1.4404-AISI 316L+AT+SL Ground Round	36	3050	h8	550
1.4404-AISI 316L+AT+SL Ground Round	36	3200	h9	74
1.4404-AISI 316L+AT+SL Ground Round	38	3050	h8	1086
1.4404-AISI 316L+AT+SL Ground Round	38	3050	h8	1952
1.4404-AISI 316L+AT+SL Ground Round	40	3050	h8	1311
1.4404-AISI 316L+AT+SL Ground Round	40	3050	h8	494
1.4404-AISI 316L+AT+SL Ground Round	40	3100	h9	214
1.4404-AISI 316L+AT+SL Ground Round	40	3100	h9	434
1.4404-AISI 316L+AT+SL Ground Round	42	3050	h8	3053
1.4404-AISI 316L+AT+SL Ground Round	45	3200	h9	301
1.4404-AISI 316L+AT+SL Ground Round	48	3100	h8	170
1.4404-AISI 316L+AT+SL Ground Round	50	3100	h10	520
1.4404-AISI 316L+AT+SL Ground Round	50	3100	h9	94
1.4404-AISI 316L+AT+SL Ground Round	50	3200	h10	474
1.4404-AISI 316L+AT+SL Ground Round	50	3200	h8	708
1.4404-AISI 316L+AT+SL Ground Round	50	3200	h9	47
1.4404-AISI 316L+AT+SL Ground Round	50	6100	h7	569
1.4404-AISI 316L+AT+SL Ground Round	52	3100	h8	366
1.4404-AISI 316L+AT+SL Ground Round	55	3050	h8	1836
1.4404-AISI 316L+AT+SL Ground Round	55	3100	h9	235
1.4404-AISI 316L+AT+SL Ground Round	56	3100	h9	2142
1.4404-AISI 316L+AT+SL Ground Round	57	3050	h8	3646

1.4404-AISI 316L+AT+SL Ground Round	57	3050	h8	306
1.4404-AISI 316L+AT+SL Ground Round	58	3050	h9	958
1.4404-AISI 316L+AT+SL Ground Round	60	3050	h8	2080
1.4404-AISI 316L+AT+SL Ground Round	60	3050	h9	480
1.4404-AISI 316L+AT+SL Ground Round	60	3050	h9	903
1.4404-AISI 316L+AT+SL Ground Round	65	3050	h8	1051
1.4404-AISI 316L+AT+SL Ground Round	70	3050	h8	939
1.4404-AISI 316L+AT+SL Ground Round	70	3050	h8	1035
1.4404-AISI 316L+AT+SL Ground Round	75	3050	h8	1398
1.4404-AISI 316L+AT+SL Ground Round	75	3050	h8	862
1.4404-AISI 316L+AT+SL Ground Round	75	3050	h8	518
1.4404-AISI 316L+AT+SL Ground Round	75	3050	h9	642
1.4404-AISI 316L+AT+SL Ground Round	80	3050	h8	2936
1.4404-AISI 316L+AT+SL Ground Round	80	6200	h11	735
1.4404-AISI 316L+AT+SL Ground Round	85	3050	h8	3050
1.4404-AISI 316L+AT+SL Ground Round	85	3100	h8	1101
1.4404-AISI 316L+AT+SL Ground Round	90	3050	h8	3521
1.4404-AISI 316L+AT+SL Ground Round	90	3100	h9	158
1.4404-AISI 316L+AT+SL Ground Round	90	3200	h9	1072
1.4404-AISI 316L+AT+SL Ground Round	100	3050	h8	2658
1.4404-AISI 316L+C700-2H Cold Drawn Round	10	3050	h9	703
1.4404-AISI 316L+C700-2H Cold Drawn Round	15	3100	h9	938
1.4410-Tp.2507+AT+SL Ground Round	75	5100	h8	176
1.4435-(AISI 316L)+AT+C-2H Cold Drawn Round	8	3050	h9	378

1.4435-(AISI 316L)+AT+C-2H Cold Drawn Round	25	3050	h9	2077
1.4435-(AISI 316L)+AT+SL Ground Round	16	3050	h9	1033
1.4435-(AISI 316L)+AT+SL Ground Round	20	3050	h8	166
1.4435-(AISI 316L)+AT+SL Ground Round	20	3050	h8	242
1.4435-(AISI 316L)+AT+SL Ground Round	20	3050	h9	803
1.4435-(AISI 316L)+AT+SL Ground Round	24	3050	h8	598
1.4462-Tp. 2205+AT+C Cold Drawn Round	8	3050	h10	672
1.4462-Tp. 2205+AT+C Cold Drawn Round	18,25	3050	h9	379
1.4462-Tp. 2205+AT+SL Ground Round	33	6100	k11	2861
1.4462-Tp. 2205+AT+SL Ground Round	33	6100	k11	2081
1.4541-AISI 321+AT+SH-2B Peeled Reeled Round	47,625	3100	h9	680
1.4542+P1070/Tp.630 H1025+C-2H Cold Drawn Round	17	3050	h9	3029
1.4542+P1070/Tp.630 H1025+C-2H Cold Drawn Round	20	5700	h9	248
1.4542+P1070/Tp.630 H1025+SH-2B Peeled Reeled Round	33,18	3020	h9	2347
1.4542+P1070/Tp.630 H1025+SH-2B Peeled Reeled Round	33,18	3020	h9	404
1.4542+P1070/Tp.630 H1025+SH-2B Peeled Reeled Round	40	3020	h9	59
1.4542+P1070/Tp.630 H1025+SL Ground Round	39,98	1510	k9	970
1.4542+P1070/Tp.630 H1025+SL Ground Round	40,4	6100	k11	1528
1.4542+P1070/Tp.630 H1025+SL Ground Round	40,6	6100	k11	1910
1.4542+P1070/Tp.630 H1025+SL Ground Round	49,98	1515	k9	1731

1.4542+P930/Tp.630 H1150+SL Ground Round	80	6200	h8	721
1.4542-Tp.630+AT+C-2H Cold Drawn Round	6	3050	h9	391
1.4542-Tp.630+AT+C-2H Cold Drawn Round	6	3050	h9	720
1.4542-Tp.630+AT+C-2H Cold Drawn Round	9	3050	h9	832
1.4542-Tp.630+AT+C-2H Cold Drawn Round	25,05	3050	h9	521
1.4542-Tp.630+AT+C-2H Cold Drawn Round	26	3050	h9	180
1.4542-Tp.630+AT+C-2H Cold Drawn Round	26	3050	h9	125
1.4542-Tp.630+AT+SL Ground Round	22	3050	h8	1005
1.4542-Tp.630+AT+SL Ground Round	25	3050	h8	536
1.4542-Tp.630+AT+SL Ground Round	25	3050	h8	252
1.4542-Tp.630+AT+SL Ground Round	25,5	3810	h9	467
1.4542-Tp.630+AT+SL Ground Round	30	3200	h7	842
1.4542-Tp.630+AT+SL Ground Round	40	3050	h9	155
1.4542-Tp.630+AT+SL Ground Round	40	3200	h8	835
1.4567+AT+C-2H Cold Drawn Round	8	3050	h9	1868
1.4570+AT+C-2H Cold Drawn Round	5	3050	h9	250
1.4570+AT+C-2H Cold Drawn Round	6	3050	h9	608
1.4570+AT+C-2H Cold Drawn Round	12	3050	h9	1005
1.4570+AT+C-2H Cold Drawn Round	12	3050	h9	993
1.4570+AT+C-2H Cold Drawn Round	12	3050	h9	587
1.4570+AT+C-2H Cold Drawn Round	12	3050	h9	990
1.4570+AT+C-2H Cold Drawn Round	12,15	3050	h9	154
1.4570+AT+C-2H Cold Drawn Round	12,15	3050	h9	121
1.4570+AT+C-2H Cold Drawn Round	12,15	3050	h9	180

1.4570+AT+C-2H Cold Drawn Round	17,6	3050	h9	938
1.4570+AT+C-2H Cold Drawn Round	17,6	3050	h9	954
1.4570+AT+C-2H Cold Drawn Round	18	3050	h9	1020
1.4570+AT+C-2H Cold Drawn Round	20	3050	h9	106
1.4570+AT+C-2H Cold Drawn Round	23,5	3050	h9	307
1.4570+AT+C-2H Cold Drawn Round	24	3050	h9	247
1.4570+AT+C-2H Cold Drawn Round	24	3050	h9	1161
1.4570+AT+C-2H Cold Drawn Round	25	3050	h9	502
1.4570+AT+C-2H Cold Drawn Round	30	3050	h9	1940
1.4570+AT+C-2H Cold Drawn Round	30	3050	h9	1072
1.4570+AT+SL Ground Round	6	3050	h7	451
1.4570+AT+SL Ground Round	24	3050	h8	440
1.4570+AT+SL Ground Round	25	3050	h7	350
1.4571-Tp.316Ti+AT+C-2H Cold Drawn Hexagon	11	3050	h11	68
1.4571-Tp.316Ti+AT+C-2H Cold Drawn Round	10	3100	h9	818
1.4571-Tp.316Ti+AT+C-2H Cold Drawn Round	13	3050	h9	323
1.4571-Tp.316Ti+AT+C-2H Cold Drawn Round	15	3050	h9	1052
1.4571-Tp.316Ti+AT+C-2H Cold Drawn Round	18	3050	h9	2064
1.4571-Tp.316Ti+AT+C-2H Cold Drawn Round	27,6	3050	h9	243
1.4571-Tp.316Ti+AT+SL Ground Round	9	3050	h8	1006
1.4571-Tp.316Ti+AT+SL Ground Round	10	3050	h8	690
1.4571-Tp.316Ti+AT+SL Ground Round	12	3050	h8	1797
1.4571-Tp.316Ti+AT+SL Ground Round	12	3050	h9	377
1.4571-Tp.316Ti+AT+SL Ground Round	12	3100	h8	891

1.4571-Tp.316Ti+AT+SL Ground Round	14	3050	h9	273
1.4571-Tp.316Ti+AT+SL Ground Round	15	3100	h8	1255
1.4571-Tp.316Ti+AT+SL Ground Round	16	3100	h8	905
1.4571-Tp.316Ti+AT+SL Ground Round	19	3050	h6	445
1.4571-Tp.316Ti+AT+SL Ground Round	19	3050	h7	504
1.4571-Tp.316Ti+AT+SL Ground Round	19	3050	h7	786
1.4571-Tp.316Ti+AT+SL Ground Round	19	3050	h8	260
1.4571-Tp.316Ti+AT+SL Ground Round	20	3100	h8	909
1.4571-Tp.316Ti+AT+SL Ground Round	20	3100	h8	4554
1.4571-Tp.316Ti+AT+SL Ground Round	20	3100	h8	477
1.4571-Tp.316Ti+AT+SL Ground Round	22	3100	h8	894
1.4571-Tp.316Ti+AT+SL Ground Round	24	3050	h8	758
1.4571-Tp.316Ti+AT+SL Ground Round	25	3100	h8	1624
1.4571-Tp.316Ti+AT+SL Ground Round	30	3100	h8	2166
1.4571-Tp.316Ti+AT+SL Ground Round	32	3200	h8	547
1.4571-Tp.316Ti+AT+SL Ground Round	35	3100	h8	988
1.4571-Tp.316Ti+AT+SL Ground Round	40	3100	h8	1272
1.4571-Tp.316Ti+AT+SL Ground Round	40	3100	h8	2312
1.4571-Tp.316Ti+AT+SL Ground Round	45	3100	h8	924
1.4571-Tp.316Ti+AT+SL Ground Round	55	3050	h9	688
1.4598 (316LCu)+AT+C-2H Cold Drawn Round	1,2	3200	h8	17,9
1.4845+AT+SL Ground Round	11,125	4267	ASTMA484	1551
1.4845+AT+SL Ground Round	15,875	4267	ASTMA484	951
100Cr6+AC+C Cold Drawn Round	8	3050	h9	1776

100Cr6+AC+C Cold Drawn Round	14,5	3050	h9	1427
100Cr6+AC+C Cold Drawn Round	15	3050	h9	836
100Cr6+AC+C Cold Drawn Round	16,5	3050	h9	400
100Cr6+AC+C Cold Drawn Round	16,5	3050	h9	1028
430FMo+RA+SL Ground Round	14,3	3150	h8	917
AISI 321 nr.1.4541+AT+C Cold Drawn Round	8	3050	h9	426
AISI 321 nr.1.4541+AT+C Cold Drawn Round	9,525	3050	h9	483
AISI 321 nr.1.4541+AT+C Cold Drawn Round	10,7	3050	h9	509
AISI 321 nr.1.4541+AT+C Cold Drawn Round	10,7	3050	h9	526
AISI 321 nr.1.4541+AT+C Cold Drawn Round	11,112	3050	h9	413
AISI 321 nr.1.4541+AT+C Cold Drawn Round	15,87	3050	h9	529
AISI 431-1.4057+A+C-2H Cold Drawn Round	13	4050	h9	307
AISI 431-1.4057+A+C-2H Cold Drawn Round	13	4050	h9	140
AISI 431-1.4057+A+C-2H Cold Drawn Round	13	4050	h9	143
AISI 431-1.4057+A+C-2H Cold Drawn Round	13	4200	h9	127
AISI 431-1.4057+A+C-2H Cold Drawn Round	13,2	3050	h9	1310
nr.1.4035+A+C Cold Drawn Round	6	3050	h9	2198
nr.1.4035+A+C Cold Drawn Round	6	3050	h9	441
nr.1.4035+A+C Cold Drawn Round	6	3050	h9	370
nr.1.4035+A+C Cold Drawn Round	6	3050	h9	302
nr.1.4035+A+C Cold Drawn Round	6	3150	h9	452
nr.1.4035+A+C Cold Drawn Round	6	3200	h9	816
nr.1.4035+A+C Cold Drawn Round	6	3700	h9	316
nr.1.4035+A+C Cold Drawn Round	6,2	3050	h9	1272

nr.1.4035+A+C Cold Drawn Round	6,2	3050	h9	857
nr.1.4035+A+C Cold Drawn Round	6,2	3050	h9	637
nr.1.4035+A+C Cold Drawn Round	6,2	3050	h9	891
nr.1.4035+A+C Cold Drawn Round	8	3050	h9	109
nr.1.4035+A+C Cold Drawn Round	8	3050	h9	268
nr.1.4035+A+C Cold Drawn Round	8	3050	h9	1966
nr.1.4035+A+C Cold Drawn Round	8	3050	h9	370
nr.1.4035+A+C Cold Drawn Round	8	3050	h9	281
nr.1.4035+A+C Cold Drawn Round	8	3050	h9	1334
nr.1.4035+A+C Cold Drawn Round	8	3050	h9	208
nr.1.4035+A+C Cold Drawn Round	8	3050	h9	442
nr.1.4035+A+C Cold Drawn Round	8	3050	h9	140
nr.1.4035+A+C Cold Drawn Round	8	3050	h9	141
nr.1.4035+A+C Cold Drawn Round	8	3050	h9	310
nr.1.4035+A+C Cold Drawn Round	8	3050	h9	200
nr.1.4035+A+C Cold Drawn Round	8	3050	h9	166
nr.1.4035+A+C Cold Drawn Round	8	3050	h9	198
nr.1.4035+A+C Cold Drawn Round	9	3050	h9	436
nr.1.4035+A+C Cold Drawn Round	9	3050	h9	236
nr.1.4035+A+C Cold Drawn Round	9,7	3630	h9	200
nr.1.4035+A+C Cold Drawn Round	10	3050	h9	590
nr.1.4035+A+C Cold Drawn Round	12	3050	h9	924
nr.1.4035+A+C Cold Drawn Round	12	3050	h9	2032
nr.1.4035+A+C Cold Drawn Round	12	3050	h9	164

nr.1.4035+A+C Cold Drawn Round	12	3050	h9	139
nr.1.4035+A+C Cold Drawn Round	12	3050	h9	160
nr.1.4035+A+C Cold Drawn Round	12	3050	h9	110

AMPKO OY  
Rajatie 4 B 23  
FIN-01230 VANTAA  
Tel. +358-(0)9-2587 6060  
<https://www.ampko.com>  
Email: [info@ampko.com](mailto:info@ampko.com)

AMPKO OY  
Rajatie 4 B 23  
FIN-01230 VANTAA  
Tel. +358-(0)9-2587 6060  
<https://www.ampko.com>  
Email: [info@ampko.com](mailto:info@ampko.com)

AMPKO OY  
Rajatie 4 B 23  
FIN-01230 VANTAA  
Tel. +358-(0)9-2587 6060  
<https://www.ampko.com>  
Email: [info@ampko.com](mailto:info@ampko.com)

AMPKO OY  
Rajatie 4 B 23  
FIN-01230 VANTAA  
Tel. +358-(0)9-2587 6060  
<https://www.ampko.com>  
Email: [info@ampko.com](mailto:info@ampko.com)

AMPKO OY  
Rajatie 4 B 23  
FIN-01230 VANTAA  
Tel. +358-(0)9-2587 6060  
<https://www.ampko.com>  
Email: [info@ampko.com](mailto:info@ampko.com)

AMPKO OY  
Rajatie 4 B 23  
FIN-01230 VANTAA  
Tel. +358-(0)9-2587 6060  
<https://www.ampko.com>  
Email: [info@ampko.com](mailto:info@ampko.com)

AMPKO OY  
Rajatie 4 B 23  
FIN-01230 VANTAA  
Tel. +358-(0)9-2587 6060  
<https://www.ampko.com>  
Email: [info@ampko.com](mailto:info@ampko.com)

AMPKO OY  
Rajatie 4 B 23  
FIN-01230 VANTAA  
Tel. +358-(0)9-2587 6060  
<https://www.ampko.com>  
Email: [info@ampko.com](mailto:info@ampko.com)

AMPKO OY  
Rajatie 4 B 23  
FIN-01230 VANTAA  
Tel. +358-(0)9-2587 6060  
<https://www.ampko.com>  
Email: [info@ampko.com](mailto:info@ampko.com)